

Amendment No. 167-80
Bylaw No. 58Z81
Council Approval: 21 April 1981

SCHEDULE B

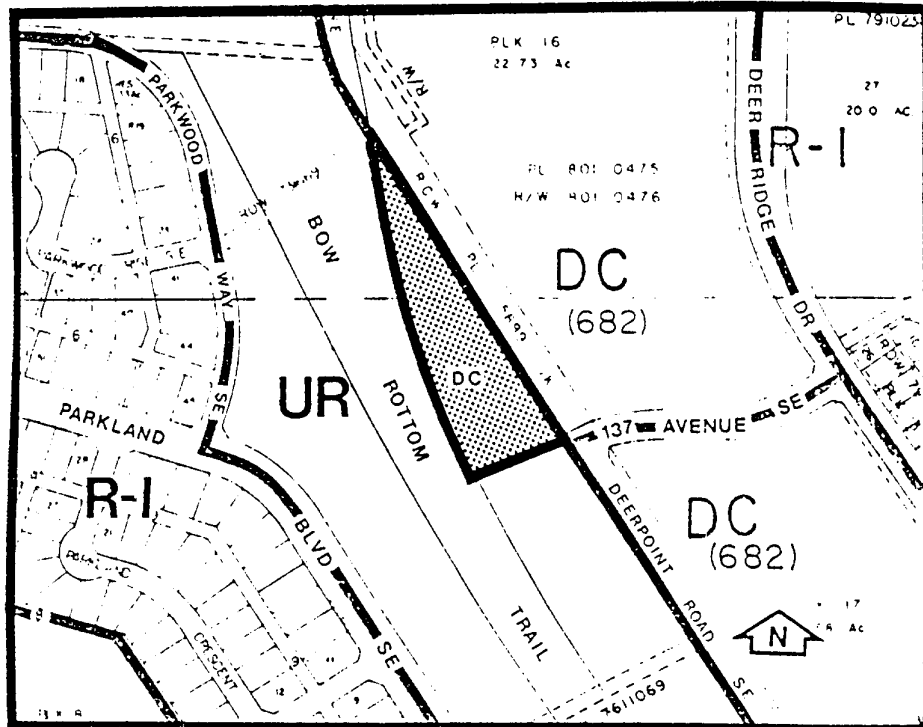

1. Land Use

The land uses shall be those Permitted and Discretionary Uses found in Section 36 of the Land Use By-law No. 2P80.

2. Development Guidelines

The General Rules for Commercial Districts contained in Section 33 of the Land Use By-law No. 2P80, and the Permitted Use Rules and Discretionary Use Rules of the C-2 General Commercial District shall apply unless otherwise noted below:

3. Building Height

A maximum of two storeys not exceeding an overall height of twelve (12) metres.

4. Comprehensive Development

The commercial development shall be a comprehensively designed scheme consistent with the character of the existing shopping centre to the east, to the satisfaction of the Development Officer.

5. Development Plans

Approval of this application in no way approves the plans as submitted. Comprehensive plans including building design, site layout, exterior finishes and colour, landscaping, parking and accesses shall be subsequently be submitted and approved prior to the release of a development permit.