

Amendment No. 81/018
Bylaw No. 12Z82
Council Approval: 18 January 1982

SCHEDULE B

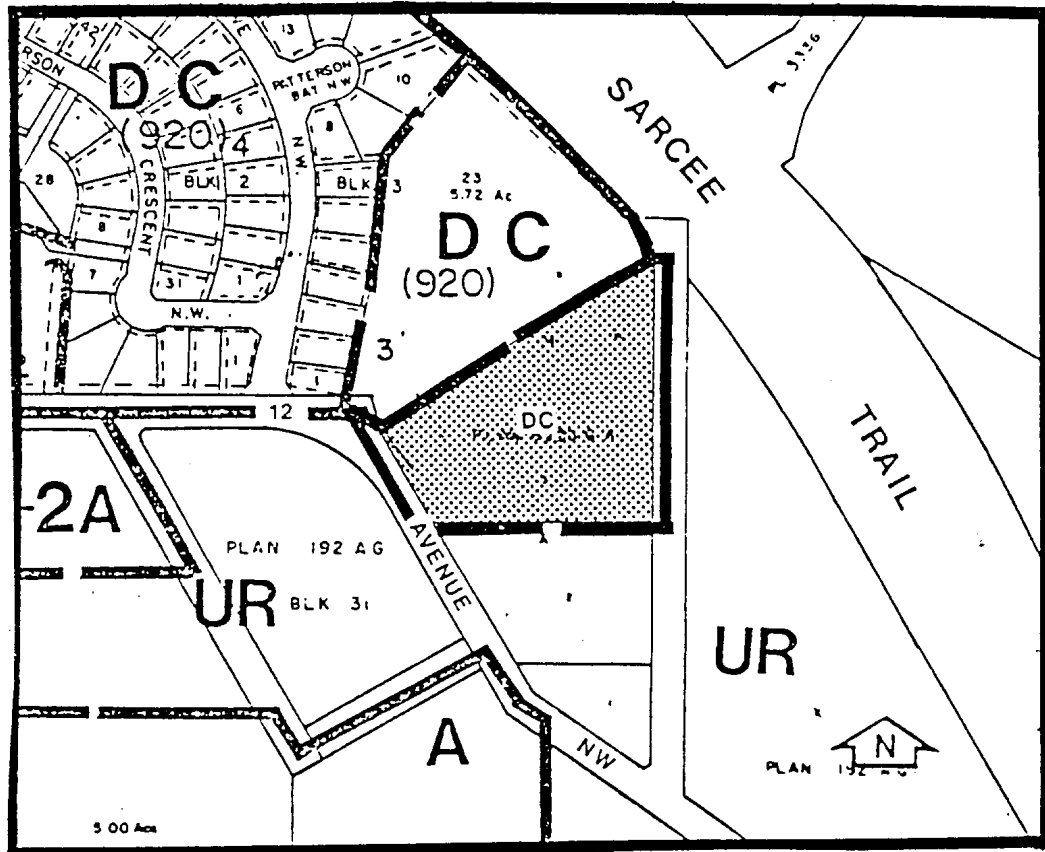

1. LAND USE

The land use shall be townhouses and apartments only.

2. DEVELOPMENT GUIDELINES

The General Rules for Residential Districts contained in Section 20 of By-law 2P80 and the Permitted and Discretionary Use Rules of the RM-1 (Residential Low Density Multi-Dwelling) District (Section 26) shall apply unless otherwise noted below.

a) Density

The maximum number of residential units permitted on the site shall be 50.

No more than 30 apartment units may be constructed on the west half of the site and such units will only be permitted on the west half of the site.

No more than 20 townhouse units may be constructed on the east half of the site and such units will only be permitted on the east half of the site.

b) Height

The height of any apartment building on the site shall not exceed 25 metres and shall not exceed an elevation of 1191 metres (Geodetic Datum).

The height of any townhouse building on the site shall not exceed 15 metres and shall not exceed an elevation of 1183 metres (Geodetic Datum).

c) Access

Access to/from the site must be provided on both the east and west sides of the site.

d) Filling

The filling of the site and its impact on the adjacent property shall be carried out to the satisfaction of the City Engineer.

e) In designing the sites, special attention shall be paid to the relationship of the buildings on this site to the site to the north such as to minimize the impact on views from that site.