

Amendment # 85/105

Bylaw # 15Z86

Council Approval: 1986 January 20

SCHEDULE B

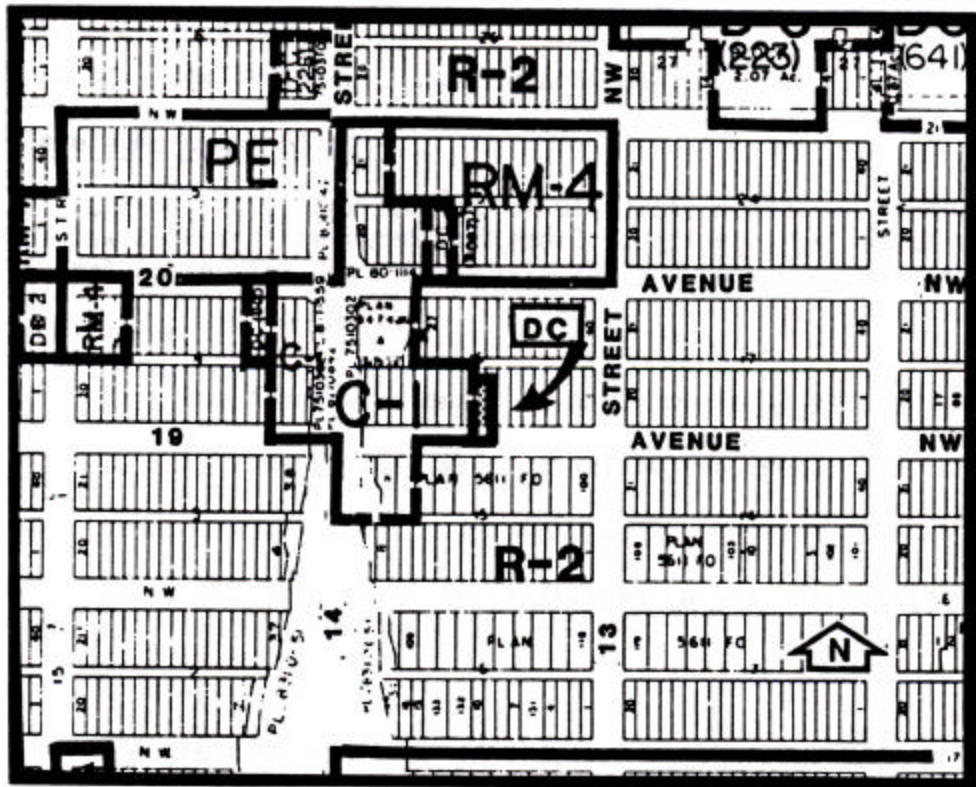

1. Land Use

The land use shall be a parking area only.

2. Development Guidelines

The General Rules for Commercial Districts contained in Section 33 of By-law 2P80 and the Permitted and Discretionary Use Rules of the C-1 (Local Commercial District) shall apply unless otherwise noted below.

a. Yards

- i. The front yard shall be a minimum of 3 metres in depth.
- ii. No side or rear yards shall be required.

b. Landscaping

The front yard shall be landscaped to the satisfaction of the Approving Authority.

c. Fencing

- i. Fencing shall be provided along the east and north property lines.
- ii. Fencing shall be provided to screen any parking which is visible from 19th Avenue N.W., to the satisfaction of the Approving Authority.

d. Access

No direct or indirect access through adjoining property shall be allowed from the site to 19th Avenue N.W.

e. Parking

The parking allowed shall be limited to parking which is accessory to the commercial development on the neighbouring site to the west, Lots 11-19, Block 16, Plan 3150 P.