

Amendment No. 88/074
Bylaw No. 95Z88
Council Approval: 14 November 1988

SCHEDULE B

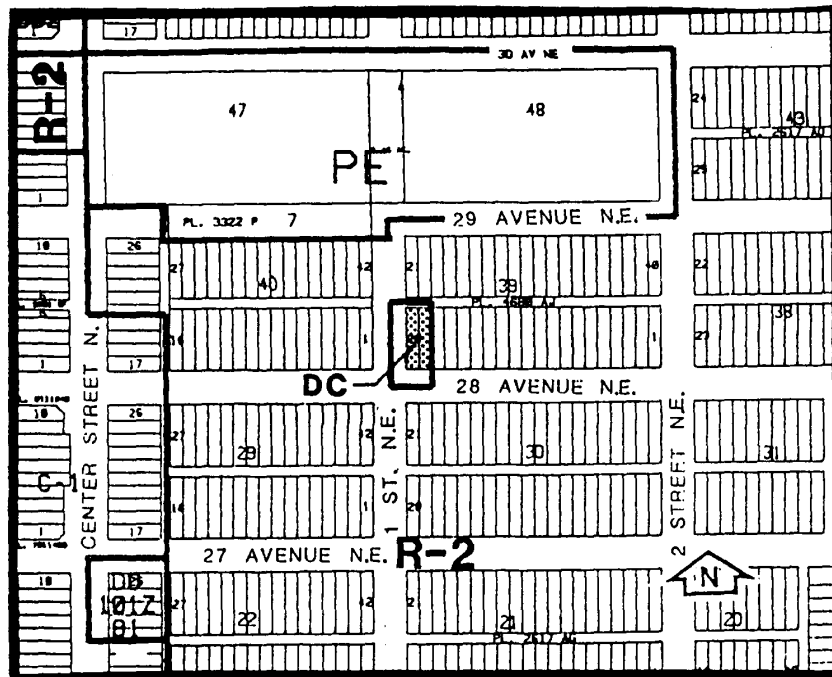

1. Land Use

The permitted and discretionary uses of the R-2 Residential District shall be the permitted and discretionary uses respectively. In addition, a child care facility for up to a maximum of 30 children at any one time and a senior's drop-in centre shall also be discretionary uses.

2. Development Guidelines

The General Rules for Residential Districts contained in Section 20 of By-law 2P80 and the Permitted and Discretionary Use Rules of the R-2 (Residential Low Density District) shall apply unless otherwise noted below.

a. Density

The maximum number of nursery school children shall be determined at the development permit stage dependant upon the final available child space but shall not exceed 30 children at any one time.

b. Building Design

The nursery school shall be located on the ground floor with the senior's drop-in centre being located on the first floor. Separate entrances shall be provided for the uses.

c. Parking

A maximum of three child care staff parking spaces shall be provided on-site.

d. Landscaping

Landscaping, uniform fencing, site development and building upgrading shall be to the satisfaction of the Approving Authority.

e. Signage

The location of any signage shall be compatible with surrounding land uses and limited in size.

f. By-lawed Setbacks

A 4.5 m x 4.5 m corner cut at 28 Avenue and 1 Street N.E. will be required to be dedicated as part of the development permit application.

g. Development Plans

Approval of this application does not constitute approval of a development permit. Comprehensive plans, including building design, site layout, exterior finishes and colour, landscaping, parking and access shall subsequently be submitted to the Approving Authority as part of a development permit application.