

**Amendment No. 91/057**  
**Bylaw No. 91Z91**  
**Council Approval: 09 December 1991**

**SCHEDULE B**

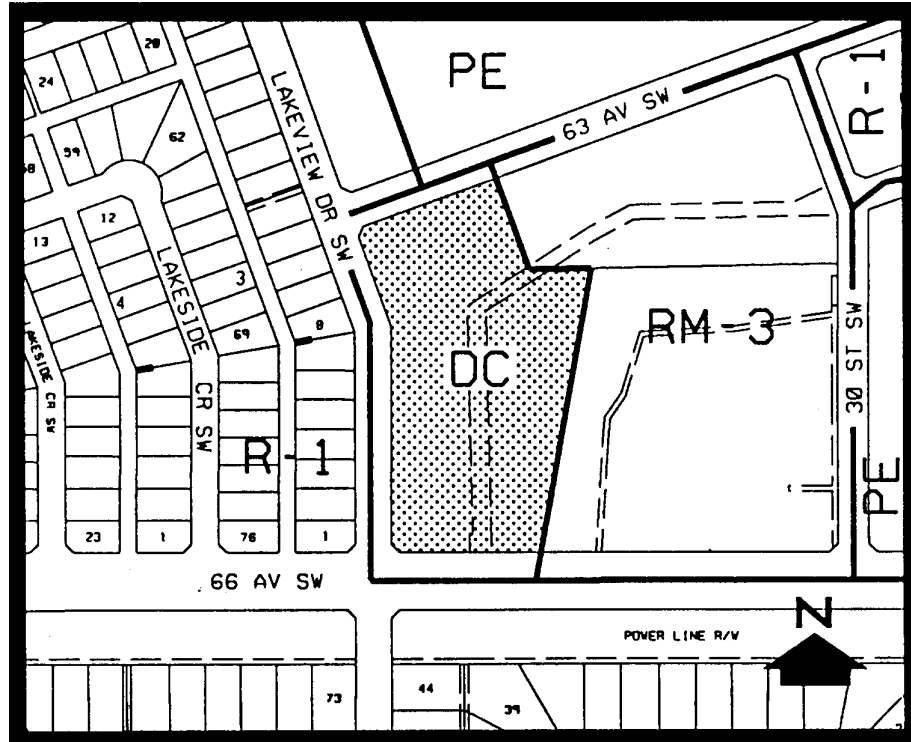

1. Land Use

The Permitted and Discretionary Uses of the RM-1 Residential Low Density Multi-Dwelling District of By-law 2P80 shall be the permitted and discretionary uses respectively with the additional Discretionary Use of semi-detached dwellings.

2. Development Guidelines

The General Rules for Residential Districts contained in Section 20 of By-law 2P80 and the Permitted and Discretionary Use Rules of the RM-1 Residential Low Density Multi-Dwelling District shall apply unless otherwise noted below.

a) Development Plans

Approval of this application does not constitute approval of a development permit. Comprehensive plans shall be submitted to the Approving Authority as part of a development permit application.