

Amendment No. 92/016
Bylaw No. 55Z92
Council Approval: 15 June 1992

SCHEDULE B

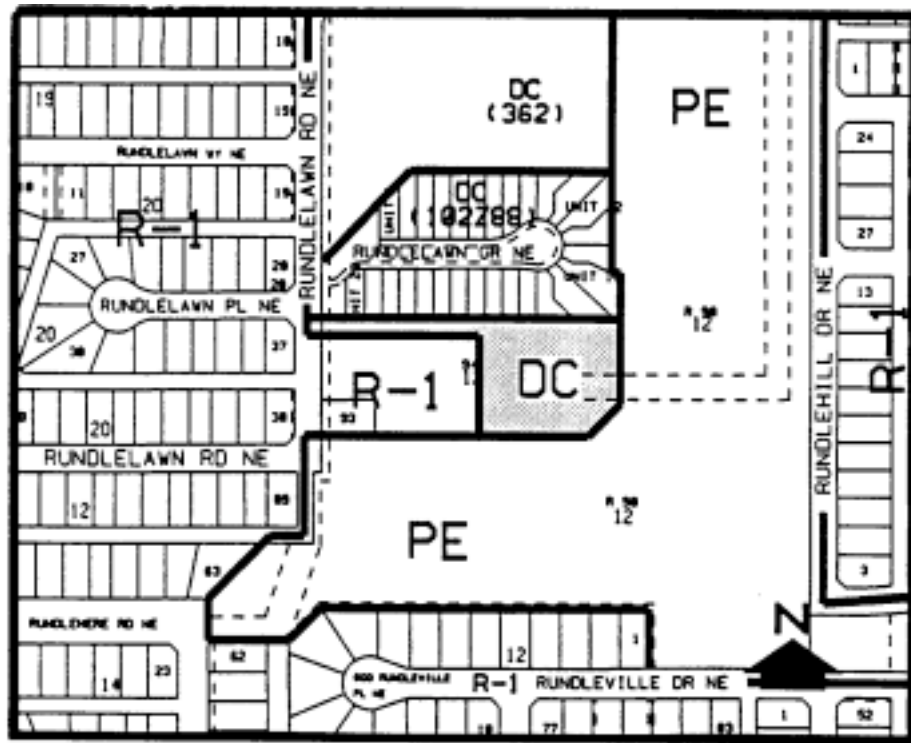

1. Land Use

The land use shall be for a comprehensively designed development of semi-detached dwellings and townhouse dwellings only for a maximum of 16 dwelling units.

2. Development Guidelines

The General Rules for Residential Districts contained in Section 20 of By-law 2P80 and the Permitted and Discretionary Use Rules of the RM-1 Residential Low Density Multi-Dwelling District shall apply unless otherwise noted below.

a) Development Plans

Approval of this application does not constitute approval of a development permit. Comprehensive plans shall be submitted to the Approving Authority as part of a development permit application.

b) Salt Water Well

The developer shall mark the well site location with a permanent marking device such as a survey control monument to the satisfaction of the City Engineer.