

**Amendment No. 93/061**  
**Bylaw No. 16Z94**  
**Council Approval: 11 April 1994**

**SCHEDULE B**

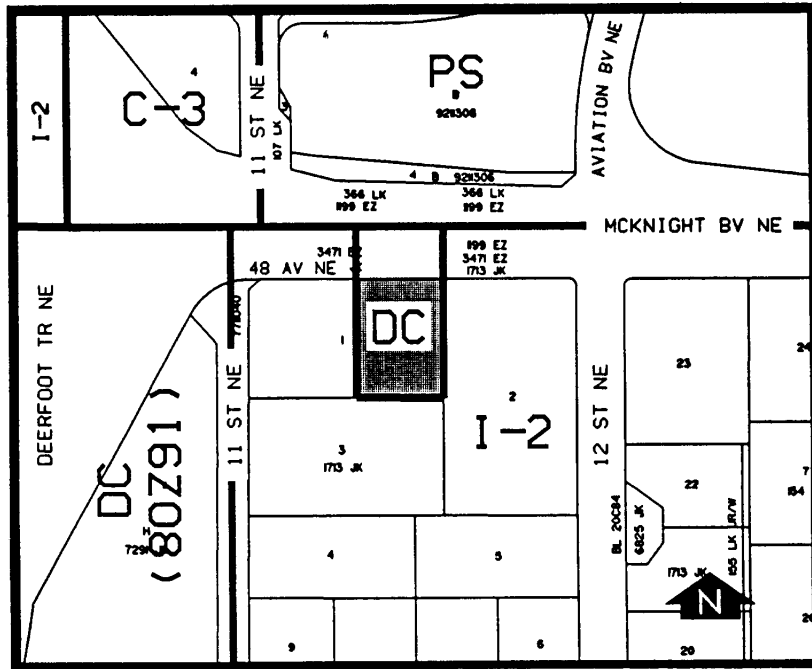

1. Land Use

The Permitted and Discretionary Uses of the I-2 General Light Industrial District of by-law 2P80 shall be the Permitted and Discretionary Uses respectively. Additionally, a church and ancillary church uses shall be discretionary uses.

2. Development Guidelines

The General Rules for Industrial Districts and the Permitted and Discretionary Use Rules of the I-2 General Light Industrial District of By-law 2P80 shall apply unless otherwise noted below.

a) Approval of this land use by-law does not constitute approval of a development permit. Comprehensive plans shall be submitted to the Approving Authority as part of a development permit application.

b) Parking

Parking provided shall not be less than the minimum requirements of By-law 2P80, and shall be provided on-site and off-site to the satisfaction of the Approving Authority.