

Amendment No. 94/037
Bylaw No. 81Z94
Council Approval: 19 September 1994

SCHEDULE B

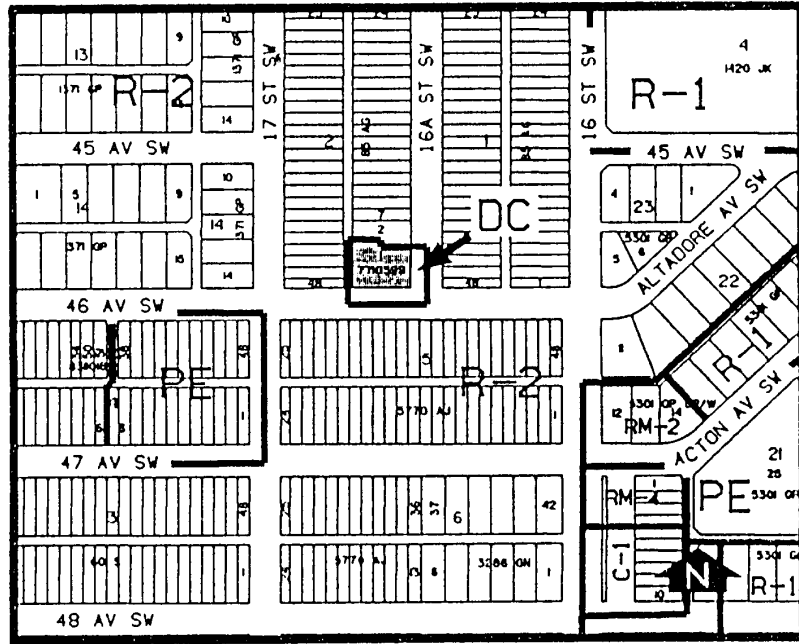

1. Land Use
 - a. The land use shall be for a child care facility only.
2. Development Guidelines
 - a. The General Rules for Residential Districts contained in Section 20 of By-law 2P80 and the Permitted and Discretionary Use Rules of the R-2 Residential Low Density District shall apply unless otherwise noted below.
 - b. Capacity

The number of children which may be approved for the facility shall be determined by the Approving Authority and is dependent upon net floor area, outdoor play space, staff parking requirements and drop-off area provided, to a maximum of 60 children.
 - c. Drop-off Area

The drop-off area shall be curbside abutting the property. No drop-off area with lane access shall be allowed.

d. Outdoor Play Space

Outdoor play space shall be provided at a minimum of 600 square metres.

e. Fencing, Landscaping and Garbage Storage

Fencing, landscaping and garbage storage shall be to the satisfaction of the Approving Authority.

f. Signage

Signage shall be limited in size, design and location and must be compatible with the residential neighbourhood to the satisfaction of the Approving Authority.

g. Development Plans

Approval of this application does not constitute approval of a development permit. Comprehensive plans shall be submitted to the Approving Authority as part of a development permit application.