

Amendment No. 95/085
Bylaw No. 2Z96
Council Approval: 08 January 1996

SCHEDULE B

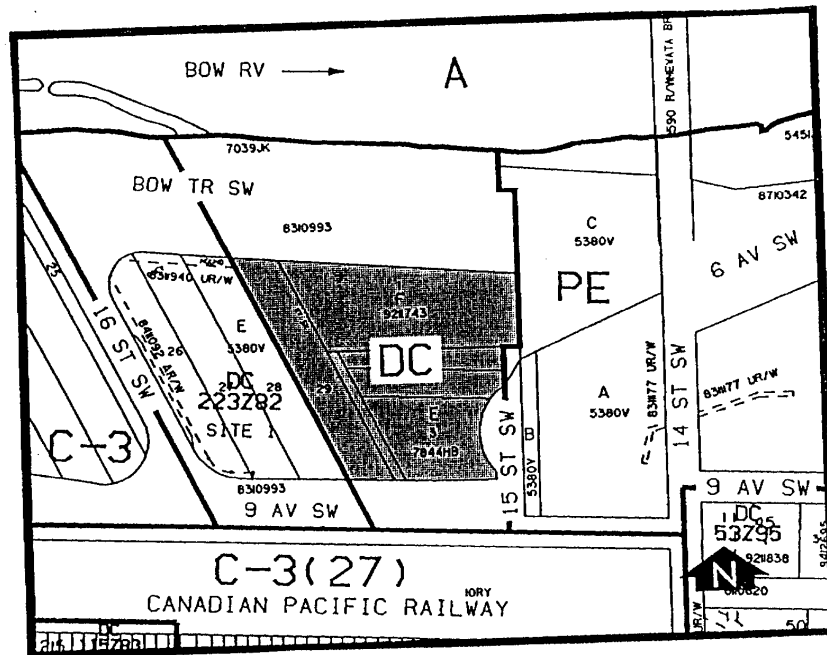

1. Land Use

The Permitted and Discretionary Uses of the C-2 General Commercial District of Bylaw 2P80 shall be the Permitted and Discretionary Uses respectively, with the additional discretionary use of a bus servicing and maintenance facility.

2. Development Guidelines

a) The General Rules for Commercial Districts contained in Section 33 of Bylaw 2P80 and the Permitted and Discretionary Use Rules of the C-2 General Commercial District shall apply.

b) Vehicular Access and Egress

No direct vehicular access or egress shall be permitted from or to Bow Trail S.W.

c) Development Plans

Approval of this application does not constitute approval of a development permit. Comprehensive plans shall be submitted to the Approving Authority as part of a development permit application.