

**Amendment No. 94/086**  
**Bylaw No. 36Z96**  
**Council Approval: June 17,1996**

**SCHEDULE B**

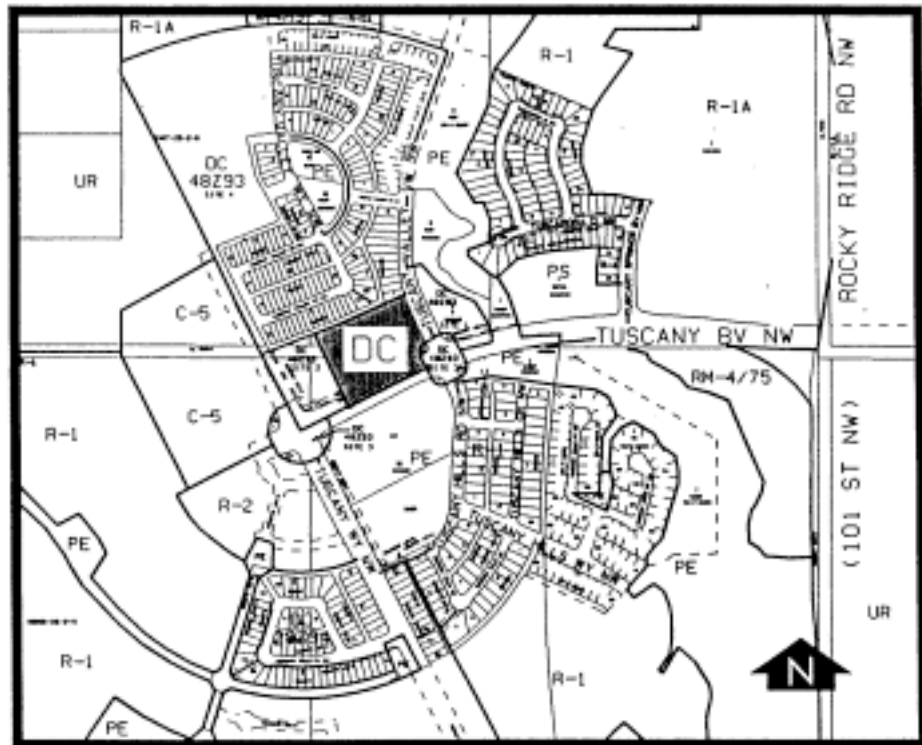

1. Land Use

The land use shall be for a recreation centre and related facilities only.

2. Development Guidelines

The General Rules for Special Districts contained in Section 48 of Bylaw 2P80 and the Permitted and Discretionary Use Rules of the PE Public Park, School and Recreation District shall apply unless otherwise noted below.

a. Subdivision Plans

The site shall be approved as one parcel of land only.

b. Development Plans

Approval of this application does not constitute approval of a development permit. Comprehensive plans shall be submitted as part of a development permit application.