

Amendment No. 97/119
Bylaw No. 36Z98
Council Approval: 20 April 1998

SCHEDULE B

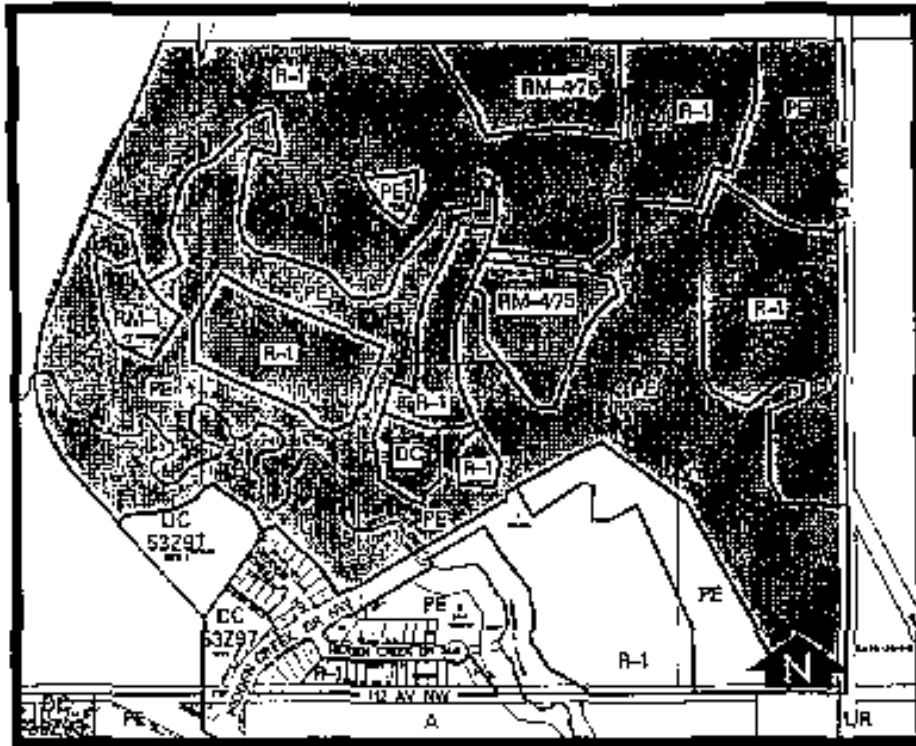

1) Land Use

The Permitted and Discretionary Uses of the R-1 Residential Single-Detached District of Bylaw 2P80 shall be the Permitted and Discretionary Uses respectively.

2) Development Guidelines

The General Rules for Residential Districts contained in Section 20 of Bylaw 2P80 and the Permitted and Discretionary Use Rules of the R-1 Residential Single-Detached District shall apply unless otherwise noted below:

a) Building Height

The maximum height for a church steeple shall be 17 metres.

**Amendment No. 97/119
Bylaw No. 36Z98**

SCHEDULE B

CONTINUED

b) Development Plans

Approval of this application does not constitute approval of a development permit. Comprehensive plans shall be submitted to the Approving Authority as part of a development permit application.