

Amendment No. 97/091
Bylaw No. 6Z98
Council Approval: 19 January 1998

SCHEDULE B

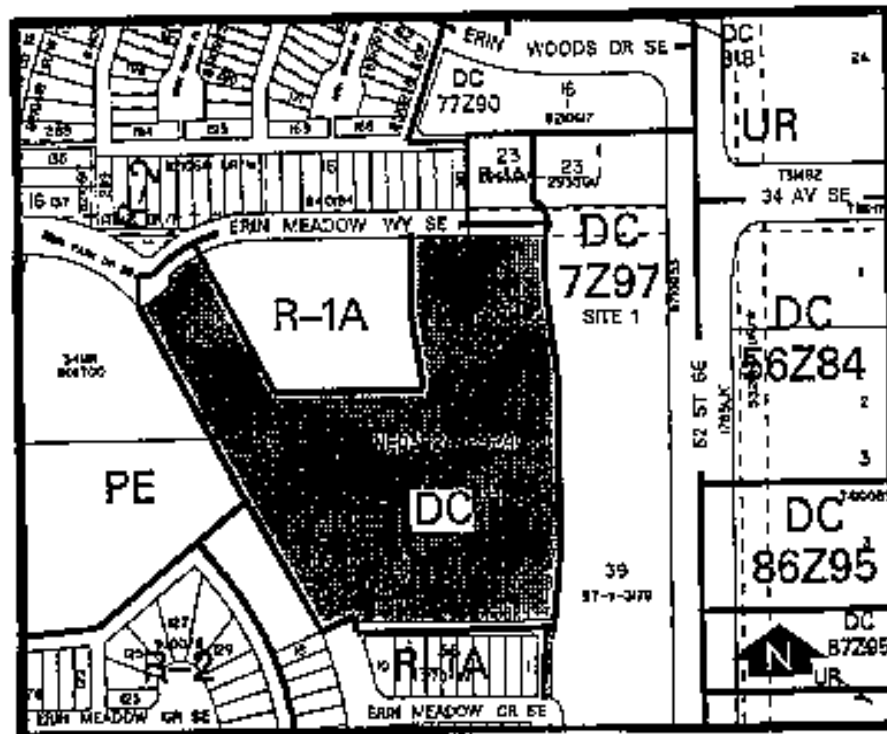

1. Land Use

The Permitted and Discretionary Uses of the R-1A Residential Narrow-Lot Single-Detached District shall be the Permitted and Discretionary Uses respectively.

2. Development Guidelines

The General Rules for Residential Districts contained in Section 20 of By-law 2P80 and the Permitted and Discretionary Use Rules of the R-1A Residential Narrow-Lot Single-Detached District shall apply unless otherwise noted below:

(1) Lot Width

- a. A minimum of 11.6 metres.
- b. A maximum of 17.0 metres, except a maximum of 18.8 metres for corner lots.

(2) Lot Depth

**Amendment No. 97/091
Bylaw No. 6Z98**

SCHEDULE B

CONTINUED

A minimum of 22 metres.

3. Development Permit Requirements

For the purpose of determining if a development permit is required, Section 8 of By-law 2P80 shall apply.