

Amendment No. 99/041
Bylaw No. 106Z99
Council Approval: 23 November 1999

SCHEDULE B

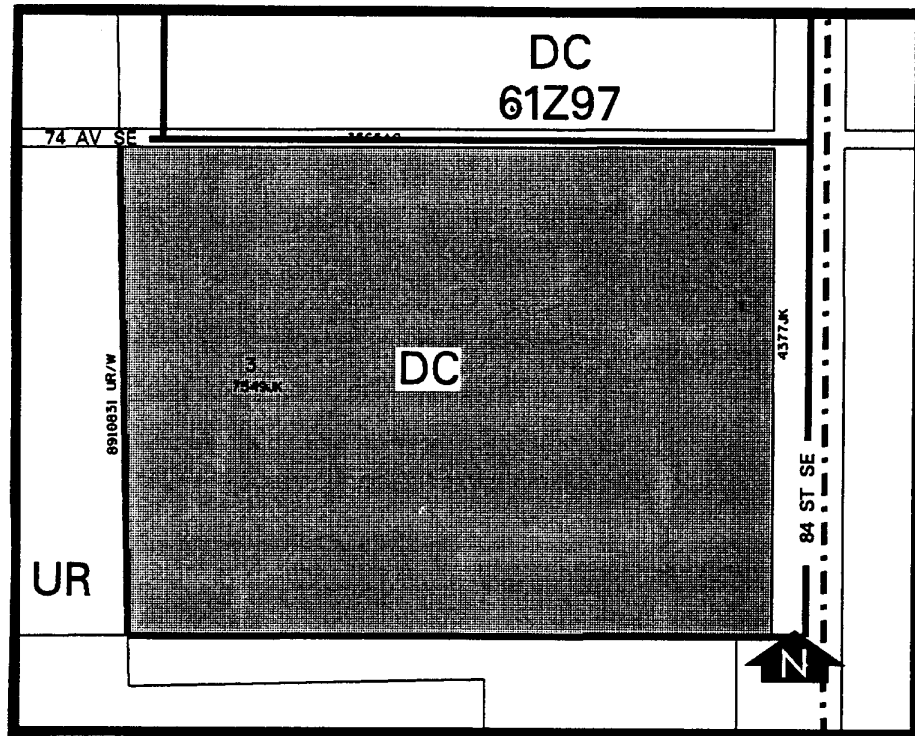

DC DIRECT CONTROL DISTRICT

1. Land Use

The Permitted and Discretionary Uses of the I-4 Limited-Serviced Industrial District of Bylaw 2P80 shall be the Permitted and Discretionary Uses respectively, with the exclusion of:

- a. Auto wrecking yards;
- b. Manufacturing, fabricating, processing, assembly, disassembly, production or packaging of materials, goods or products;
- c. Scrap metal yards.

2. Development Guidelines

The General Rules for Industrial Districts contained in Section 43 of Bylaw 2P80 and the Permitted and Discretionary Use Rules of the I-4 Limited-Serviced Industrial District shall apply unless otherwise noted below:

- a. Stormwater Management

A stormwater management report shall be submitted to the satisfaction of the City Engineer prior to release of the development permit.

b. Site Area

The minimum site area shall be 10.04 ha± (24.81 ac±).

c. Screening

Development on the site shall be compatible with the overall standard of development for general light industrial areas with regard to landscaping, building design and screening of storage, with special emphasis given to the future Glenmore Trail interchange, and to the satisfaction of the Approving Authority.

d. Development Plans

Approval of this application does not constitute approval of a Development Permit. Comprehensive detailed plans shall be submitted to the Development Authority as part of the Development Permit application.