

**Amendment No. 98/084**  
**Bylaw No. 6Z99**  
**Council Approval: 18 January 1999**

**SCHEDULE B**

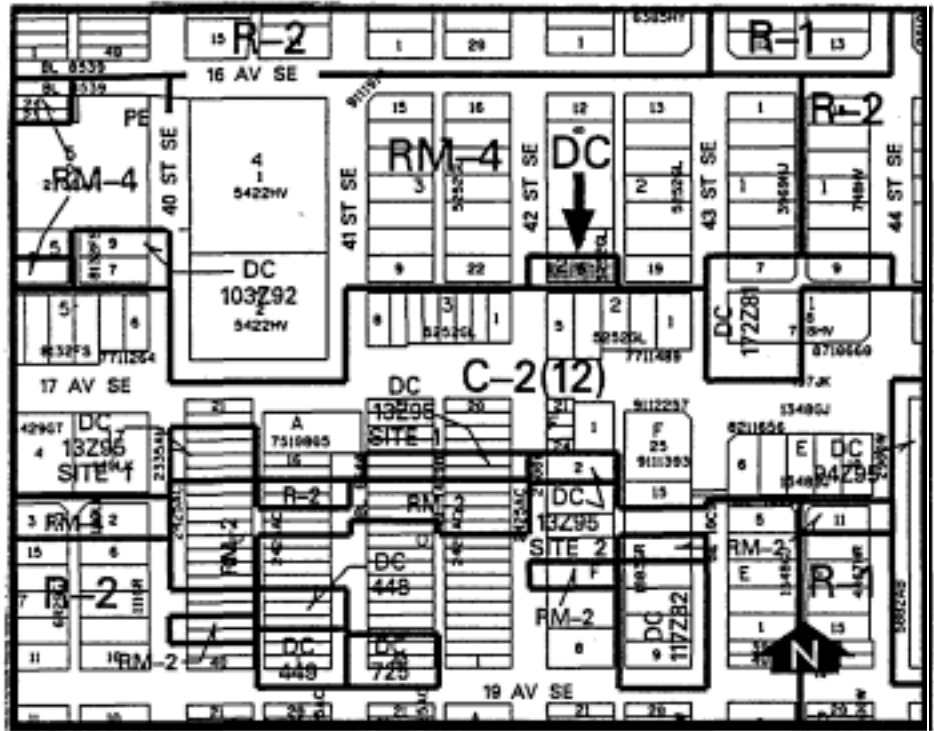

1. Land Use

The Permitted and Discretionary Uses of the RM-4 Residential Medium Density Multi-Dwelling District of Bylaw 2P80 shall be the Permitted and Discretionary Uses respectively with the additional Discretionary Use of a surface parking area for the exclusive use of 4214 - 17 Avenue SE.

2. Development Guidelines

The General Rules for Residential District contained in Section 20 of Bylaw 2P80 and the Permitted and Discretionary Use Rules of the RM-4 Residential Medium Density Multi-Dwelling District shall apply for residential development, and General Rules for Commercial Districts contained in Section 33 of Bylaw 2P80 and the Permitted and Discretionary Use Rules of the C-2 General Commercial Districts shall apply to the surface parking area unless otherwise noted below.

a) Landscape Buffer

A five metre landscaped buffer shall be located along the northerly property line.

b) Development Plans

Approval of this application does not constitute approval of a development permit. Comprehensive plans shall be submitted to the Development Authority as part of a development permit application.