

Amendment No. 99/024
Bylaw No. 83Z99
Council Approval: 19 July 1999

SCHEDULE B

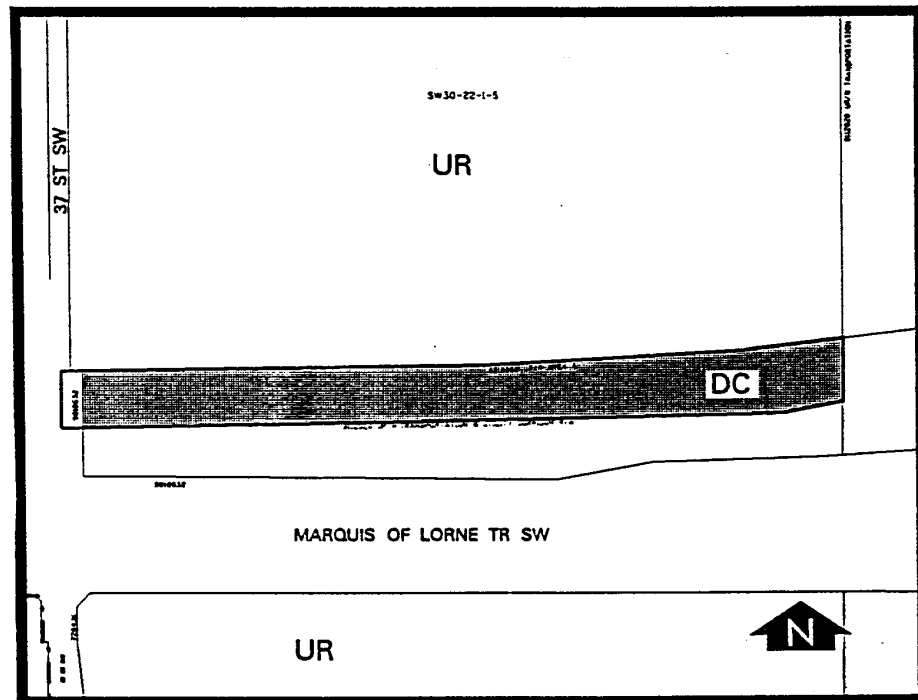

1. Land Use

The land use shall be for a cemetery, a chapel, caretaker's residence and accessory uses.

2. Development Guidelines

The General Rules for Special Districts as contained in Section 48 of Bylaw 2P80 and the Permitted and Discretionary Use Rules of the A Agricultural and Open Space District shall apply to the cemetery uses unless otherwise noted below:

a. Vehicular Access and Egress

Primary vehicular access/egress to the site shall only be on a temporary basis from 37 Street until an internal road system has been constructed which enables access/egress to be obtained from it.

b. Fencing

Fencing of the site and cemetery areas shall be to the satisfaction of the Approving Authority.

c. Residence

The design of the residence and accessory uses shall reflect the general character of a residential area.

d. Landscaping

A detailed landscaping plan shall be submitted as part of a development permit application and shall be to the satisfaction of the Approving Authority.

e. Development Plans

Approval of this application does not constitute approval of a development permit; comprehensive plans shall be submitted to the Approving Authority as part of a development permit application.