

Amendment No. 2000/046
Bylaw No. 88Z2000
Council Approval: 21 August 2000

SCHEDULE B

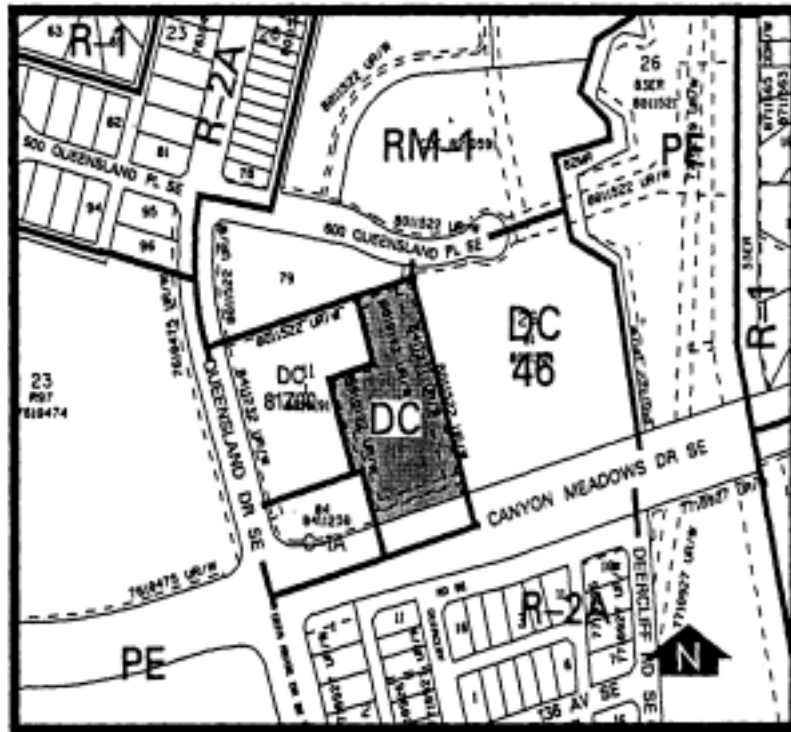

1. Land Use
The Discretionary Use shall be a comprehensively designed apartment development.
2. Development Guidelines
The General Rules for Residential Districts contained in Section 20 of Bylaw 2P80 and the Permitted and Discretionary Use Rules of the RM-4/100 Residential Medium Density Multi-Dwelling District shall apply unless otherwise noted below:
 - a. Density
A maximum of 60 dwelling units.
 - b. Rear Yard
A minimum depth of 7.0 metres.
 - c. Parking

A minimum of 82 parking stalls shall be provided on site, of which tandem parking stalls will count towards the total.

d. Development Plans

Approval of this application does not constitute approval of a development permit. Comprehensive plans shall be submitted to the Approving Authority as part of a development permit application. In considering such an application, the Approving Authority shall ensure the building design and site layout conform substantially with the plans and renderings submitted to City Council during their consideration of this Bylaw.