

**Amendment No. 99/089**  
**Bylaw No. 93Z2000**  
**Council Approval: 24 July 2000**

**SCHEDULE B**

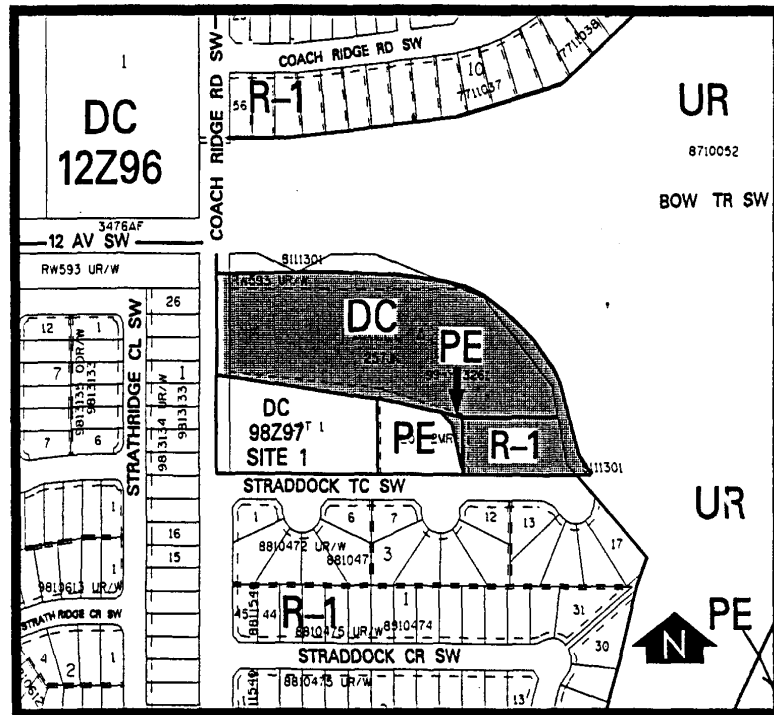

(1) Land Use

The land use shall be for a comprehensively designed semi-detached and/or single-detached residential development only.

(2) Development Guidelines

The General Rules for Residential Districts contained in Section 20 of Bylaw 2P80 and the Permitted and Discretionary Rules of the RM-1 Residential Low Density Multi-Dwelling District shall apply unless otherwise noted below:

a) Site Area

The maximum site area shall be 1.4 hectares± (3.5 acres±).

b) Density

A maximum of 26 dwelling units.

c) Development Plans

Approval of this application does not constitute approval of a development permit. Comprehensive plans shall be submitted to the Approving Authority as part of a development permit application.