

Amendment # 2001/087
Bylaw # 114Z2001
Council Approval: 2001 October 11

SCHEDULE B

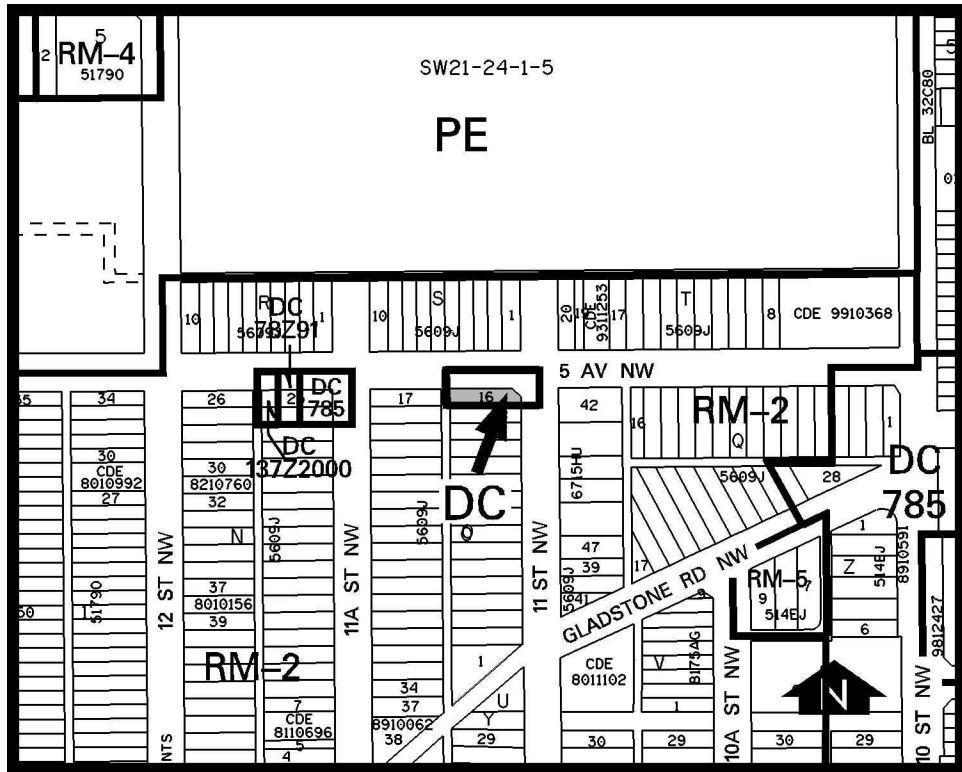

DC DIRECT CONTROL DISTRICT

1. Land Use
 - (a) Permitted Uses
 - Home occupations – Class 1
 - Utilities

(b) Discretionary Uses

Dwelling units
Grocery stores
Home occupations – Class 2 (N.P.)
Offices
Personal service businesses
Retail stores

2. Development Guidelines

The General Rules for Commercial Districts contained in Section 33 of Bylaw 2P80 and the Permitted and Discretionary Use Rules of the C-1 Local Commercial District shall apply unless otherwise noted below:

(a) Commercial Development

- (i) Only those uses which, in the opinion of the Development Authority, are oriented to local area needs and have a low impact on parking or traffic shall be allowed in this district; and
- (ii) Any change in intensity of use or any change of use shall require a Development Permit application. No use permits shall be issued for this site.
- (iii) Any development permit application for commercial development shall be accompanied by a traffic and parking study.

(b) Parking

Parking requirements shall be at the discretion of the Development Authority.

(c) Outside Storage

No outside storage of material, equipment or commercial vehicles shall be allowed on the site.