

**Amendment # 2000/111
 Bylaw # 15Z2001
 Council Approval: 2001 February 12**

SCHEDULE B

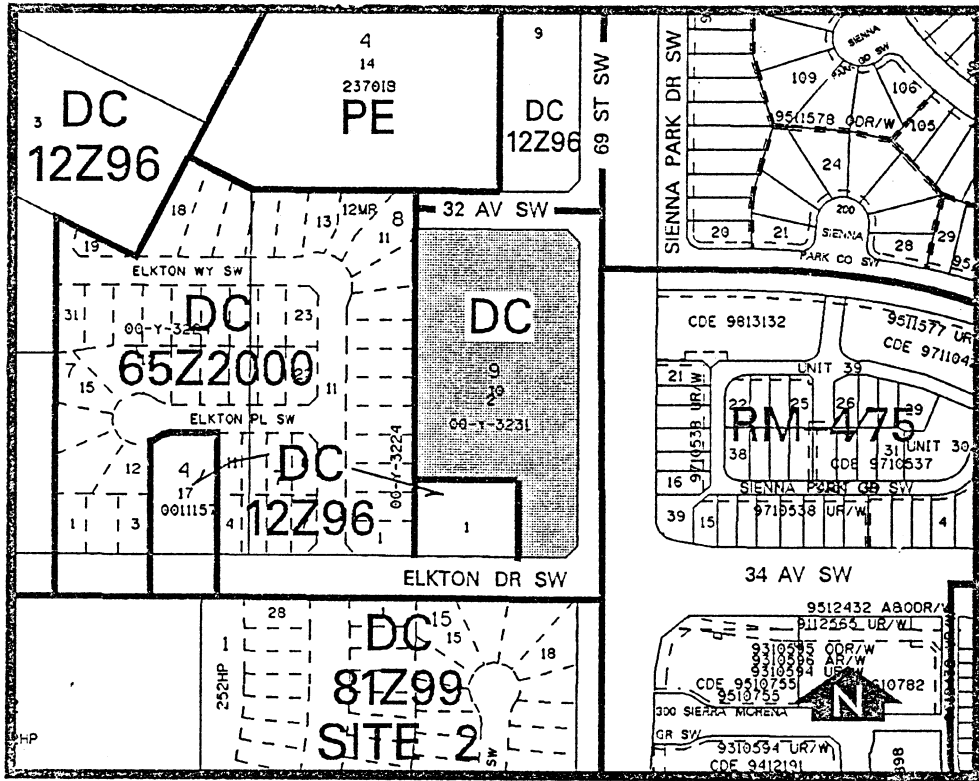

DC DIRECT CONTROL DISTRICT

1. Land Use

The land use shall be for a private school only.

2. Development Guidelines

The General Rules for Special Districts contained in Section 48 of By-law 2P80 and the Permitted and Discretionary Use Rules of the PS Public Service District shall apply unless otherwise noted below:

- (a) Access

No direct vehicular access will be permitted to or from 69 Street SW or 32 Avenue SW.
- (b) Enrollment

The maximum number of students shall not exceed 300 ranging from kindergarten to Grade 12.
- (c) Portable Classrooms

No portable classrooms shall be permitted.
- (d) Building Height

A maximum of two storeys not exceeding an overall height of 10 metres.
- (e) Building Coverage

A maximum of 40 percent of the site.
- (f) Parking

Parking shall be provided in accordance with Section 18 of Bylaw 2P80 for elementary and junior high schools and senior high schools.
- (g) Passenger Drop-off and Bus Loading

Passenger drop-off, bus loading areas and parking for the school shall be provided on-site to the satisfaction of the Development Authority.
- (h) Fencing

A uniform screen fence and/or appropriate landscape berming shall be constructed abutting the residential developments and 69 Street SW, to the satisfaction of the Development Authority.
- (i) Landscaped Area

Landscaped areas shall be provided in accordance with Section 51(3)(b) of Bylaw 2P80.
- (j) Architectural Guidelines

The design, character and appearance of the building shall be compatible with and complementary to the surrounding residential developments.
- (k) Services

Any relocation of overhead power lines will be at the applicant's expense and to the satisfaction of ENMAX.

(l) Development Plans

Approval of this application does not constitute approval of a development permit. Comprehensive plans shall be submitted to the Development Authority as part of a development permit application.