

Amendment # 2001/022
Bylaw # 65Z2001
Council Approval: 2001 August 13

SCHEDULE B

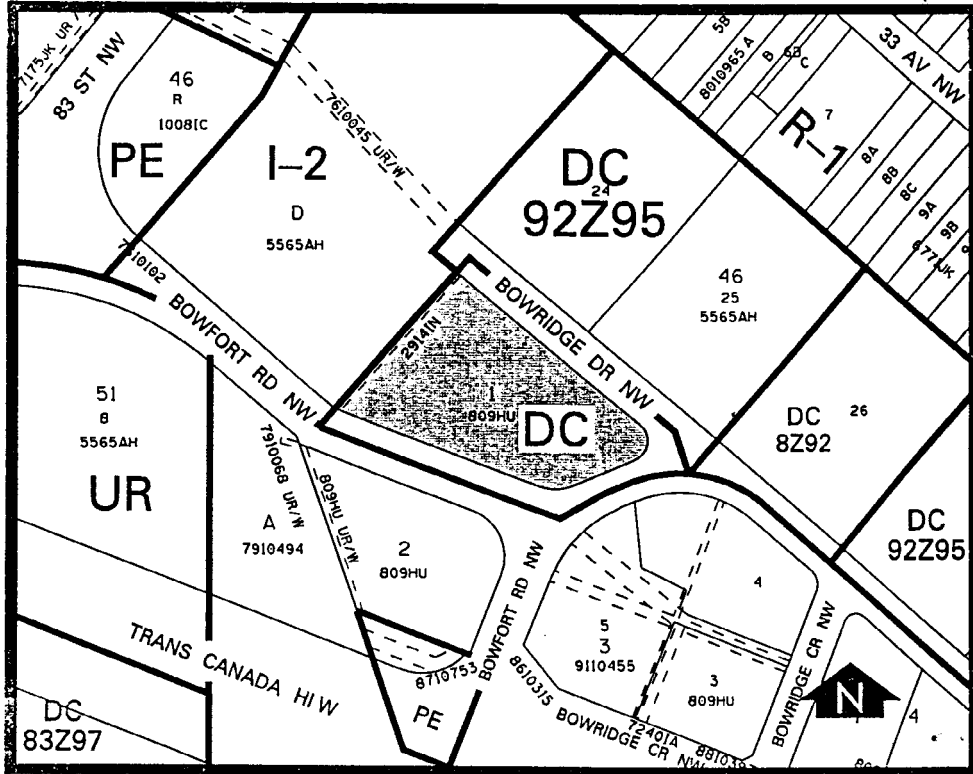

DC DIRECT CONTROL DISTRICT

1. Land Use

The land use shall be for automotive sales and rentals of new vehicles only as a Discretionary Use.

2. Development Guidelines

The General Rules for Commercial Districts contained in Section 33 of Bylaw 2P80 and the Permitted and Discretionary Use Rules of the C-6 Highway Commercial District shall apply unless otherwise noted below:

(a) Height

The maximum building height, including ancillary structures shall be 9.0 metres.

(b) Landscaping and Yards

All yards except for the westerly yard shall be landscaped to a minimum depth of 6.0 metres.

(c) Outdoor Speaker Systems

There shall be no outdoor loudspeakers or paging systems.

(d) Lighting

Outdoor lighting shall be low intensity, low scale and directed towards the ground surface, so as to minimize the impact on the surrounding areas, to the satisfaction of the Approving Authority.

(e) Rooftop Equipment

Rooftop equipment shall be located and screened to minimize visual and auditory impacts to the satisfaction of the Approving Authority.

(f) Signage

A comprehensive signage proposal that includes restricting free-standing and rooftop signs to a maximum height of 12.0 metres above existing grade shall be submitted to the satisfaction of the Approving Authority.