

Amendment # 2000/108
Bylaw # 91Z2001
Council Approval: 2001 September 10

SCHEDULE B

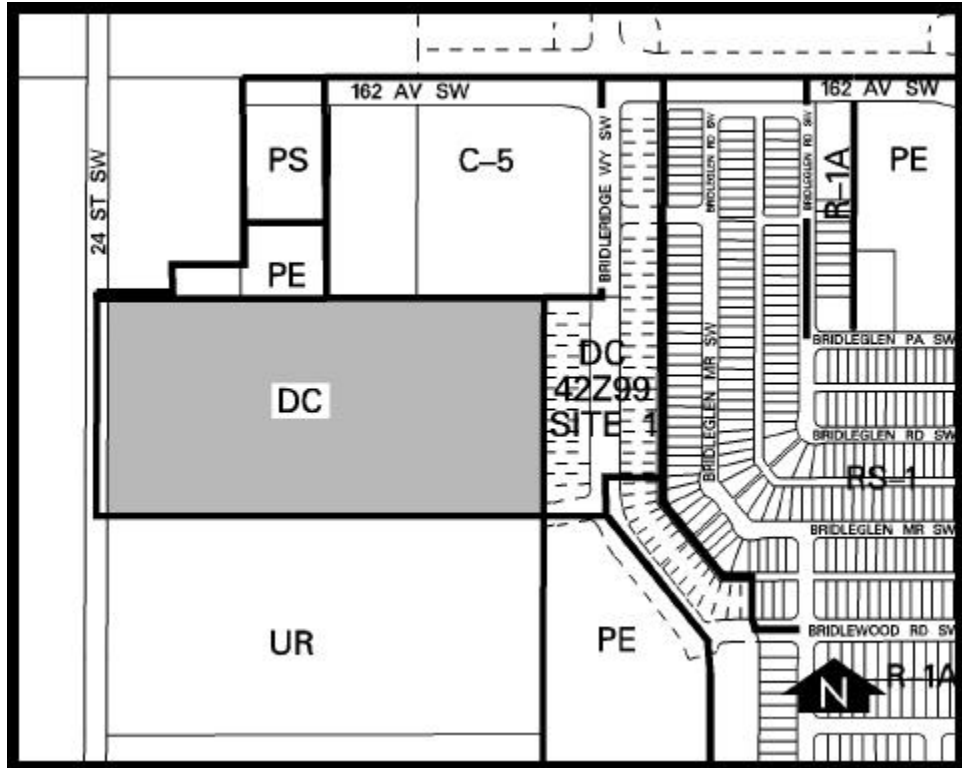

DC DIRECT CONTROL DISTRICT

1. Land Use

The land uses shall be for a private school and ancillary school activities, and a public and quasi-public building in the form of a church.

2. Development Guidelines

The General Rules for Special Districts contained in Section 48 of Bylaw 2P80 and the Permitted and Discretionary Use Rules of the PE Public Park School and Recreation District shall apply unless otherwise noted below:

(a) Student Capacity

The maximum capacity of the private school shall be 600 students.

(b) Parking

In addition to the requirements of Section 18 of Bylaw 2P80, bus parking shall be provided on site to the satisfaction of the Development Authority.

(c) Landscaped Areas

The following areas shall be landscaped:

- (i) the front yards;
- (ii) an area adjacent to the south property line shall be landscaped as a front yard;
- (iii) any minimum required side or rear yard where there is no intervening playfield or play area between the building and the street;
- (iv) any area between a parking area and the school building and between a parking area and an abutting residential district; and
- (v) all adjoining City boulevards.

(d) Development Setback

When considering a development permit application for the site, the Development Authority shall require, in addition to any yard requirement, that the building be set back a minimum of 0.44 metres from 24 Street SW and a minimum of 10.5 metres from the future Bridlewood Road right-of-way along the south boundary of the site.