

Amendment # 2001/058
Bylaw # 96Z2001
Council Approval: 2001 September 10

SCHEDULE B

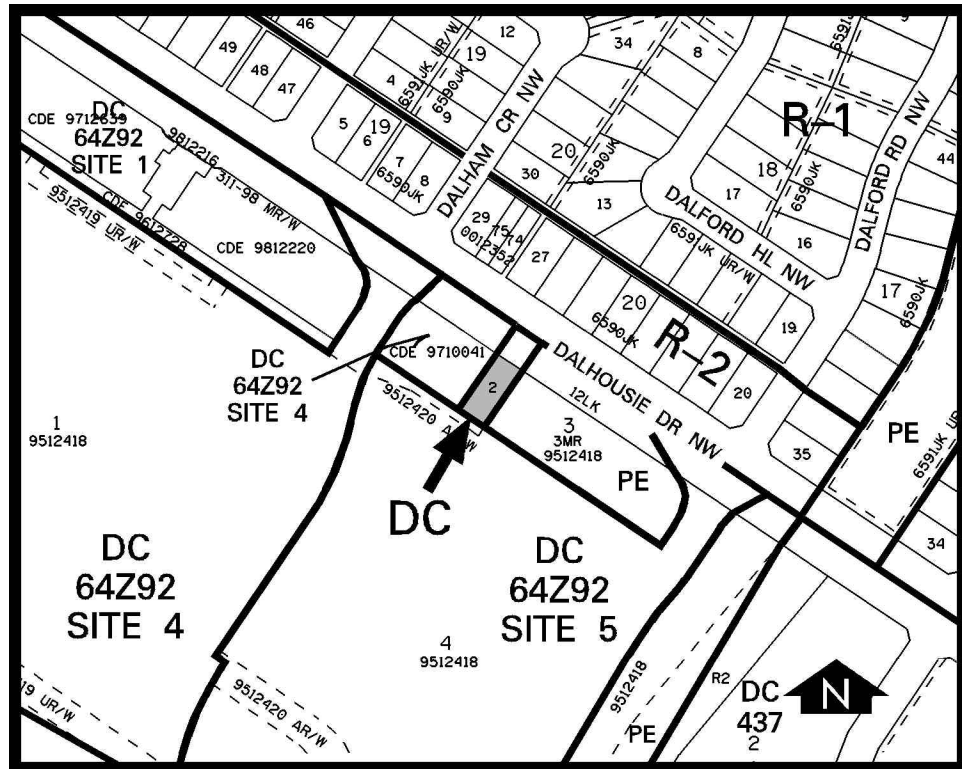

DC DIRECT CONTROL DISTRICT

1. Land Use

The Discretionary Uses shall be for a child care facility, or for a medical clinic and dwelling unit only.

2. Development Guidelines

The General Rules for Residential Districts contained in Section 20 of By-law 2P80 and the Permitted and Discretionary Use Rules of the R-1 Residential Single-Detached District shall apply unless otherwise noted below:

(a) Medical Clinic

(i) No more than two medical practitioners shall be allowed at any one time.

(ii) Signage

Signage shall be limited to two fascia signs satisfactory to the Approving Authority.

(iii) Building Height

A maximum of 11.5 metres.

(iv) Medical clinics shall only be developed in a manner which substantially conforms to the plans and renderings submitted to City Council during their consideration of this Bylaw.

(b) Child Care Facility

(i) Density

A maximum capacity of 80 children.

(ii) Access

A drop-off area on Dalhousie Drive NW and right turns in and out vehicular access to Dalhousie Drive NW for staff parking only shall be to the satisfaction of the General Manager, Planning and Transportation Policy.

(iii) Play Areas

Outdoor play areas shall only be to the side or rear of the building.

(iv) Signage

Signage shall be limited to one only, which shall not be greater than 600 mm by 1.2 m (2 ft. by 4 ft.).