

Amendment # AM2001/096
Bylaw # 11Z2002
Council Approval: 2002 March 11

SCHEDULE B

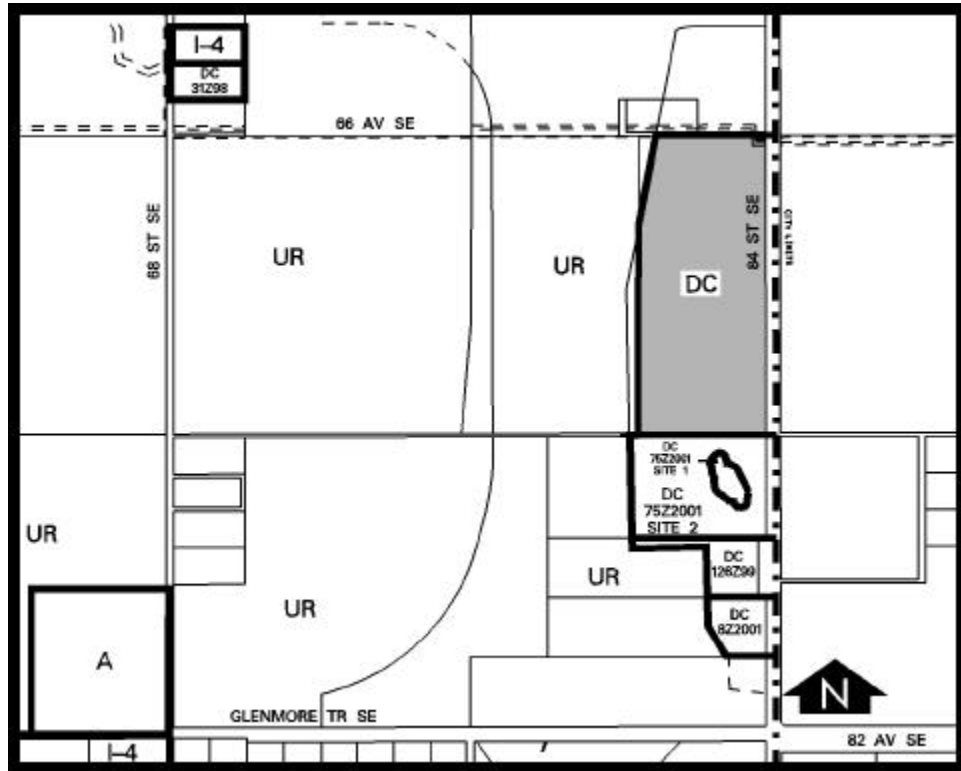

DC DIRECT CONTROL DISTRICT

1. Land Use
 - (a) Permitted Uses:
 - Essential Public Services
 - Signs – Class 1
 - Signs – Class 2 – freestanding identification only
 - Utilities

(b) Discretionary Uses:

Accessory buildings

Accessory uses

Automotive specialities

Business offices accessory to any use

Cleaning, servicing, testing or repairing

Custodial quarters

Manufacturing, fabricating, processing, assembly, disassembly, production, or packaging of materials, goods or products

Movement or storage of materials, goods or products

Recreational and commercial vehicle repair, service, sales and rentals

2. Development Guidelines

The General Rules for Industrial Districts contained in Section 43 of Bylaw 2P80 and the Permitted and Discretionary Use Rules of the I-2 General Light Industrial District shall apply unless otherwise noted below.

(a) Lot Area

A minimum of 8 hectares.