

Amendment # LOC 2001-0035
Bylaw # 29Z2002
Council Approval April 25 2002

SCHEDULE B

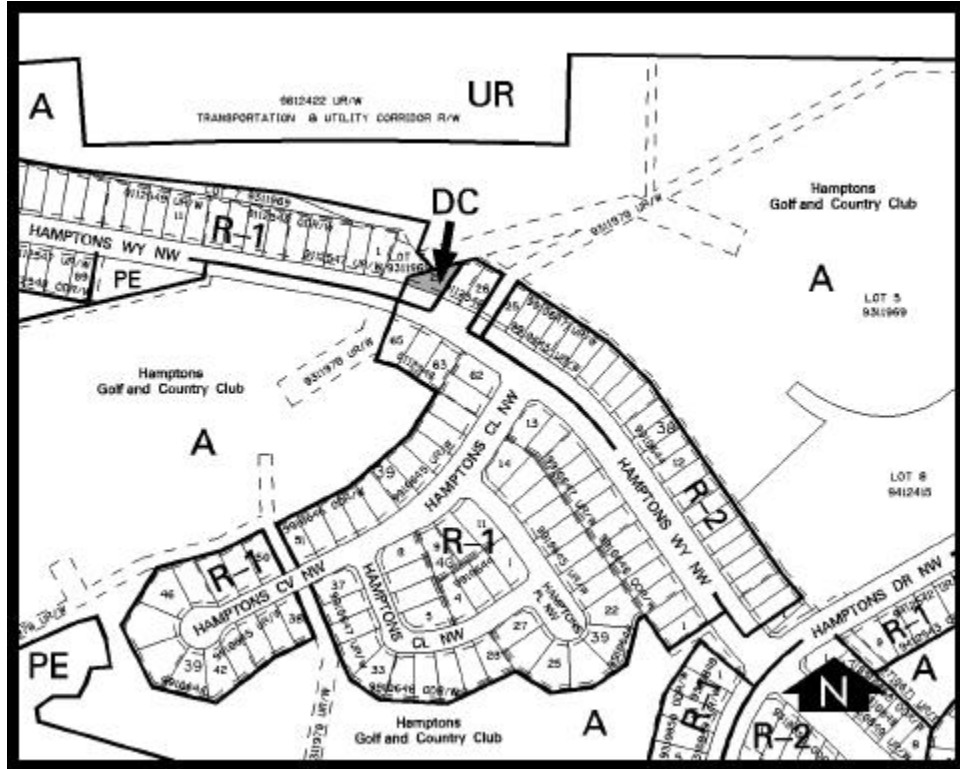

DC DIRECT CONTROL DISTRICT

1. Land Use

The Permitted and Discretionary Uses of the R-1 Residential Single Detached District of Bylaw 2P80 shall be the Permitted and Discretionary Uses respectively with the additional discretionary use of an office for the purposes of land development.

2. Development Guidelines

The General Rules for Residential Districts contained in Section 20 of Bylaw 2P80 and the Permitted and Discretionary Use rules of the R-1 Residential Single Detached District shall apply unless otherwise noted below:

a) Office Floor Area

The maximum net floor area for an office use shall be 135 square metres.

b) Office Parking

Notwithstanding the requirements of Section 18 of Bylaw 2P80, where an office use is provided, parking shall be provided as follows:

- (i) three parking stalls shall be provided in an attached garage and assigned to staff; and,
- (ii) three visitor parking stalls shall be provided on the driveway in front of the attached garage.

c) Signage

Notwithstanding the Appendix - Sign Regulations in Bylaw 2P80, no signage shall be permitted for the office use.

d) Development Permit for Office Use

The development permit shall not be issued for an office use beyond 31 December 2008