

Amendment # LOC2003-0018
Bylaw # 54Z2003
Council Approval: 2003 June 18

SCHEDULE B

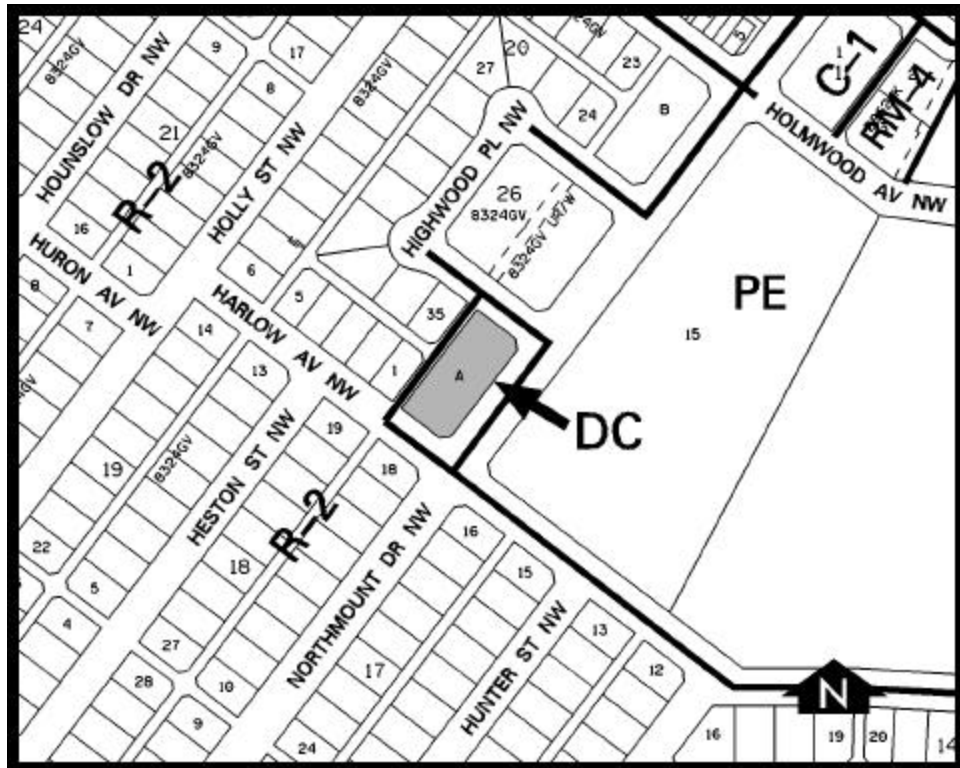

DC DIRECT CONTROL DISTRICT

1. Land Use

The Permitted and Discretionary Uses of the R-2 Residential Low Density District of Bylaw 2P80 shall be the Permitted and Discretionary Uses respectively with the additional Discretionary Use of a private school within the building existing on the site on the date of passage of this Bylaw.

2. Development Guidelines

The General Rules for Residential Districts contained in Section 20 of Bylaw 2P80 and the Permitted and Discretionary Rules of the R-2 Residential Low Density District shall apply unless otherwise noted below:

(a) Private Schools

- (i) A private school (Grades 1 and 2) shall only be developed in conjunction with the existing church.
- (ii) A maximum school enrollment of 32 students.
- (iii) No portable classrooms shall be allowed.
- (iv) A detailed operational plan including drop off/ pick up times for students shall be submitted to the Approving Authority as part of a development permit application.
- (v) Signage shall be limited in size, design, and location and must be compatible with the residential neighbourhood to the satisfaction of the Approving Authority.