

**Amendment # LOC2002-0057
Bylaw # 17Z2004
Council Approval: 2004 March 15**

SCHEDULE B

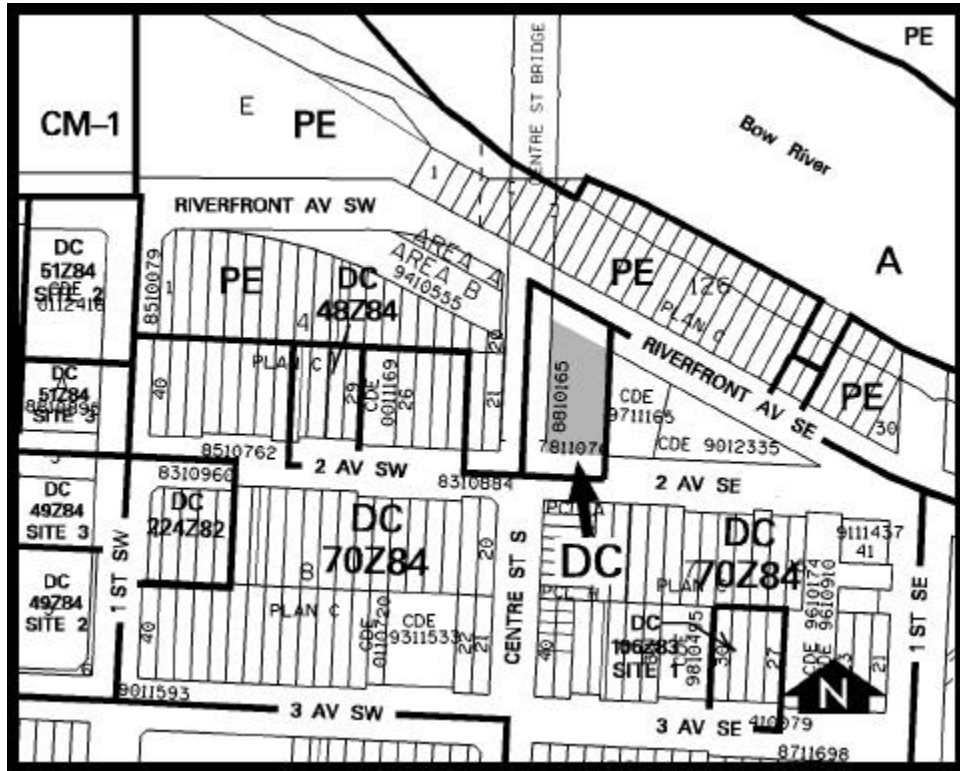

DC DIRECT CONTROL DISTRICT

1. Land Use

The Land Use shall be for a comprehensively designed parking structure and utilities as Permitted Uses and parking areas (at grade) as a Discretionary Use.

2. Development Guidelines

The General Rules for Downtown Districts contained in Section 42.1 of Bylaw 2P80 and the Permitted and Discretionary Use Rules of the CM-2 Downtown Business District shall apply unless as otherwise noted below:

Amendment # LOC2002-0057 Bylaw # 17Z2004

SCHEDULE B

CONTINUED

(a) Development Plans

Approval of this application does not constitute approval of a development permit. Comprehensive plans shall be submitted to the Development Authority as part of a development permit application. In considering such an application, the Development Authority shall ensure that the building design and site layout substantially conform with the plans and renderings available to City Council during its consideration of this Bylaw.