

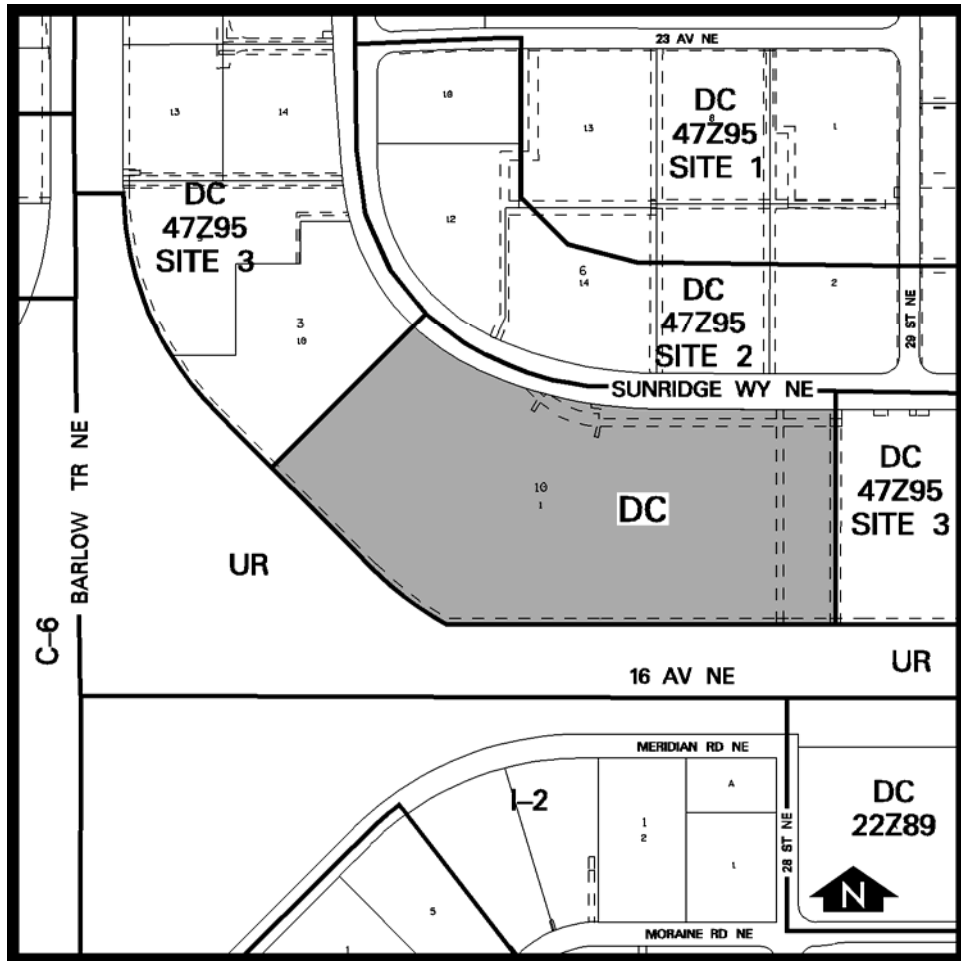

**Amendment # LOC2004-0060**  
**Bylaw # 87Z2004**  
Council Approval: December 13, 2004

**SCHEDULE B**



**DC DIRECT CONTROL DISTRICT**

1. Land Use

The Permitted Uses of the I-2 General Light Industrial District shall apply excluding auto body and paint shops, greenhouses and nurseries and veterinary hospitals.

The Discretionary Uses of the I-2 General Light Industrial District shall be the Discretionary Uses with the additional Discretionary Uses of personal service business, retail food stores,

# Amendment # LOC2004-0060

## Bylaw # 87Z2004

### SCHEDULE B

#### CONTINUED

retail stores and medical clinics and excluding amusement arcades, bottle return depots, flea markets, gaming establishments – bingo, intensive agricultural uses and kennels.

Certainty of Use (C.U) is afforded to the following:

- Drinking Establishments
- Entertainment Establishments
- Financial Institutions
- Hotels and Motels
- Medical Clinics
- Restaurant – Food Service Only
- Restaurant Licensed
- Retail Food Store
- Retail Stores

#### 2. Development Guidelines

The General Rules for Industrial Districts contained in Section 43 of Bylaw 2P80 shall apply to all uses and the Permitted Use Rules of the I-2 General Light Industrial District shall apply to Permitted Uses and the Discretionary Use Rules of the I-2 General Light Industrial District shall apply to Discretionary Uses unless otherwise noted below.

##### (a) Floor Area

For the purpose of this Bylaw the requirements of Section 45(5)(e)(i) and (ii) shall not apply.

##### (b) Access and Egress

No direct vehicular access is permitted to or from either 16 Avenue NE or Barlow Trail NE or any associated interchanges and ramps.