

Amendment No. 86/073  
Bylaw No. 112Z86  
Council Approval: 08 September 1986

SCHEDULE B

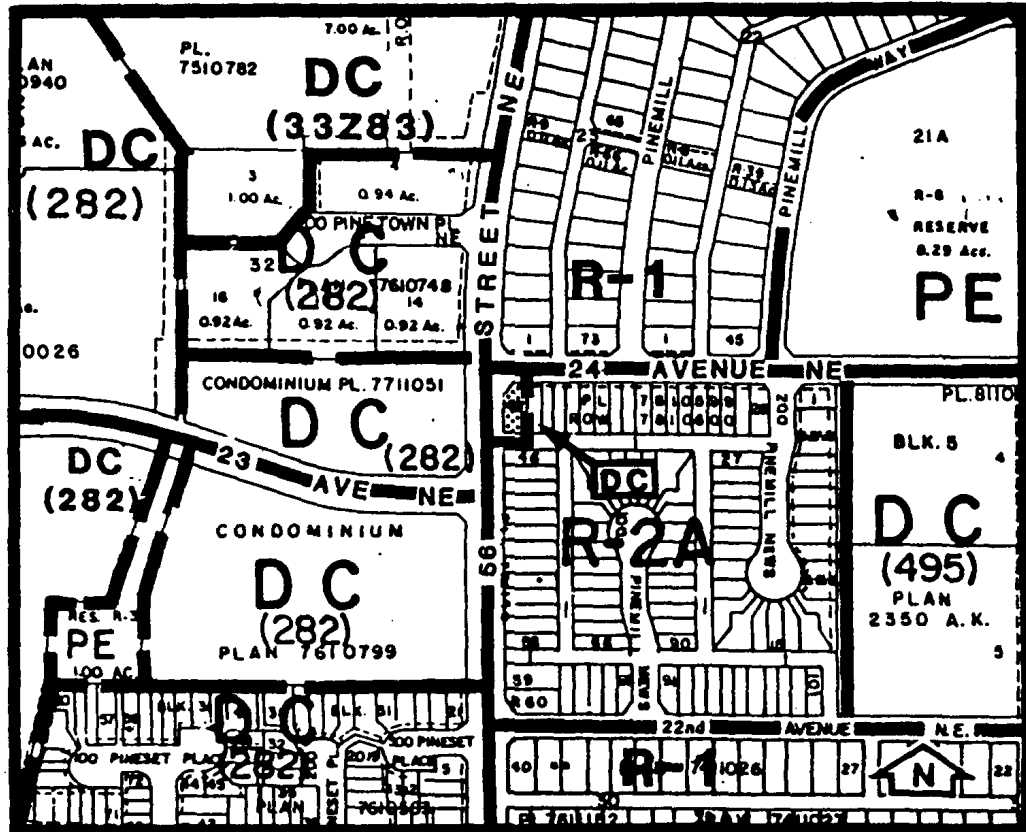

1. Land Use

The permitted uses of the R-1 Residential Low Density District shall be permitted uses and the discretionary uses of the R-1 District shall be discretionary uses with the addition of child care facilities for up to and including 20 pre-school children.

2. Development Guidelines

The General Rules for Residential Districts contained in Section 20 of By-law 2P80 and the Permitted and Discretionary Use Rules of the R-1 District shall apply unless otherwise noted below.

a. Signage

Signage shall be limited in size, design and location and must be compatible with a residential neighbourhood to the satisfaction of the Approving Authority.

b. Parking

A minimum of 1 stall for every 2 staff members shall be provided in the rear yard.

c. Fencing

The outdoor play area and parking area shall be fenced to the satisfaction of the Approving Authority.

d. Development Plans

Approval of this application does not constitute approval of a development permit. Comprehensive plans, including building design, site layout, exterior finishes and colour, landscaping, parking and access shall subsequently be submitted to the Approving Authorities as part of a development permit application.