

**Amendment No. 86/144**  
**Bylaw No. 32Z87**  
**Council Approval: 13 April 1987**

**SCHEDULE B**

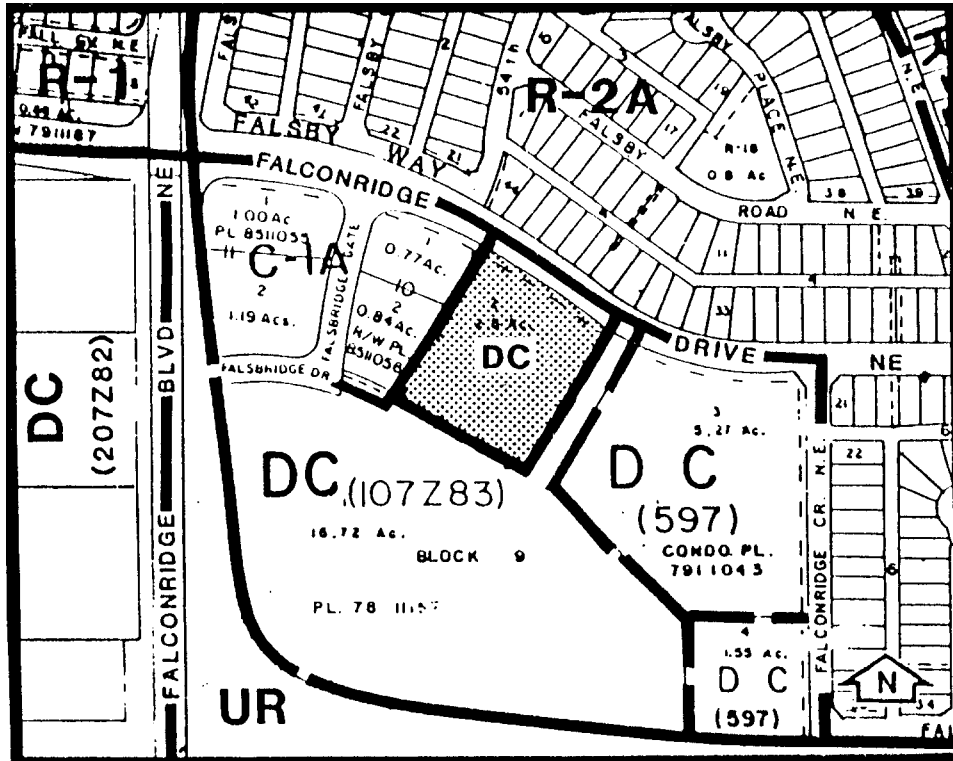

1. Land Use

The permitted and discretionary uses shall be the permitted and discretionary uses of the C-1A Local Commercial District respectively plus a drinking establishment as a further discretionary use.

2. Development Guidelines

The General Rules for Commercial Districts contained in Section 33 of By-law 2P80 and the Permitted and Discretionary Use Rules of the C-1A (Local Commercial District) shall apply unless otherwise noted below.

a. Development Plans

Approval of this application does not constitute approval of a development permit. Comprehensive plans, including building design, site layout, exterior finishes and colour, landscaping, parking and accesses shall subsequently be submitted to the Approving Authorities as part of a development permit application.