

Amendment No. 89/067
Bylaw No. 126Z89
Council Approval: 11 December 1989

SCHEDULE B

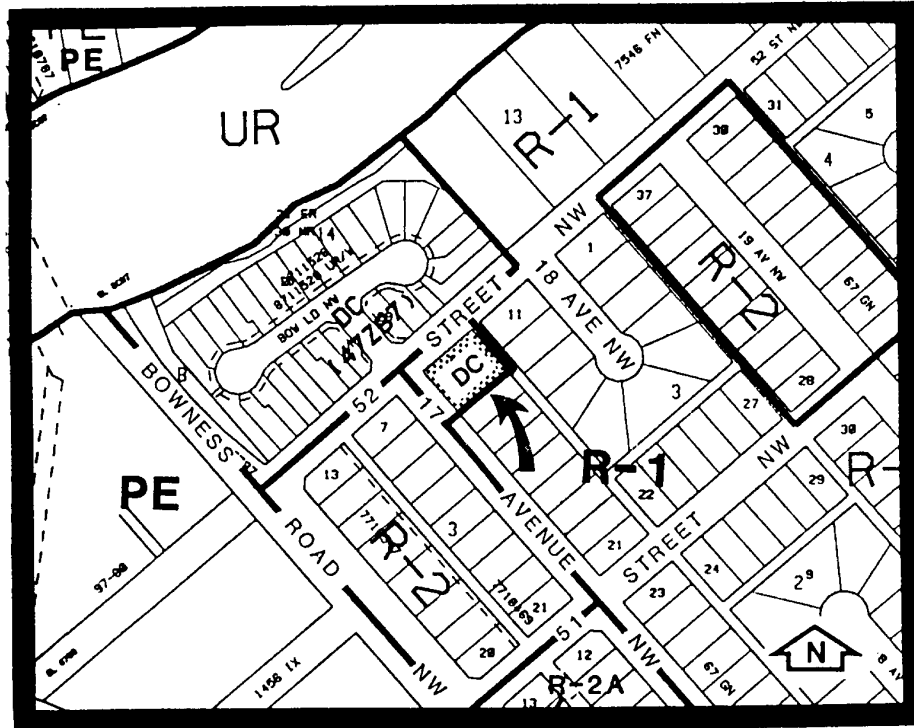

1. Land Use

The land use shall be for single-detached residential dwellings only.

2. Development Guidelines

The General Rule for Residential Districts contained in Section 20 of By-law 2P80 and the Permitted and Discretionary Use Rules of the R-1 District shall apply unless otherwise noted below.

a) Lot Frontage

A minimum of 9.75 metres (32 feet).

b) Lot Area

A minimum of 356.7 square metres (3840 sq. ft.).

c) Front Yard

A minimum of 9.14 metres (30 feet).

d) Development Plans

Approval of this application does not constitute approval of a development permit. Comprehensive plans, including building design, site layout, exterior finishes and colour, landscaping, parking and accesses shall subsequently be submitted to the Approving Authorities as part of a development permit application.