

**Amendment No. 90/116  
Bylaw No. 80Z96  
Council Approval: July 22, 1996**

**SCHEDULE B**

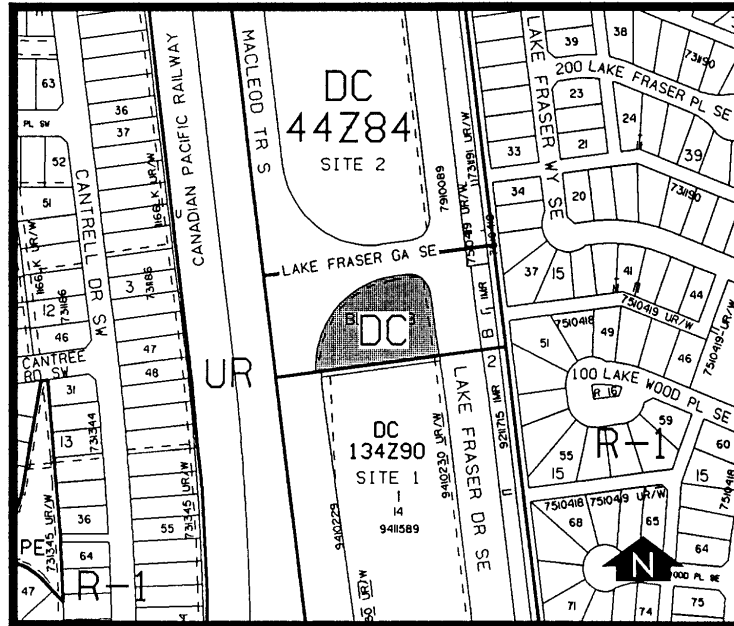

1. Land Use

The land use shall be the permitted and discretionary uses of the C-1A Local Commercial District with the additional use of a funeral home as a discretionary use.

2. Development Guidelines

The General Rules for Commercial Districts and the Permitted and Discretionary Use Rules for the C-1A Local Commercial District contained in Sections 33 and 35 respectively of Bylaw 2P80 shall apply unless otherwise noted below:

a. Parking

For a funeral home the number of parking stalls required, stall dimensions, and parking layout shall be subject to the satisfaction of the Development Authority.

b. Development Plans

Approval of this application does not constitute approval of a development permit. Comprehensive plans, including the building design, site layout, exterior finishes and colour, landscaping, parking and access shall be subsequently submitted to the Development Authority as part of a development permit application.