

Amendment No. 97/102
Bylaw No. 24Z98
Council Approval: 16 March 1998

SCHEDULE B

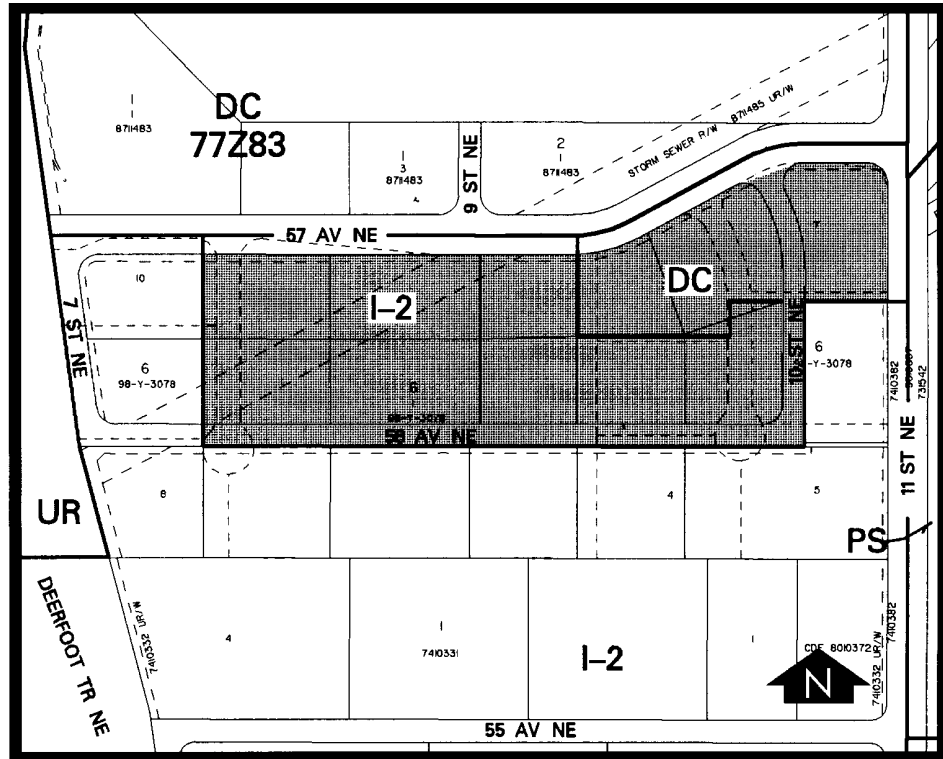

1. Land Use

The Permitted and Discretionary uses of the I-2 General Light Industrial District shall be the Permitted and Discretionary Uses respectively with the additional use of "Retail store".

2. Development Guidelines

The General Rules for Industrial Districts contained in Section 43 of Bylaw 2P80 and the Permitted and Discretionary Use Rules of the I-2 General Industrial District shall apply unless otherwise noted below:

a) Restaurants

Restaurant size shall only be restricted by the ability of the site to provide sufficient parking in accordance with the requirements of Bylaw 2P80.

**Amendment No. 97/102
Bylaw No. 24Z98**

SCHEDULE B

CONTINUED

b) Development Plans

Approval of this application does not constitute approval of a development permit. Comprehensive plans shall be submitted to the Development Authority as part of a development permit application.