

Amendment No. 97/059
Bylaw No. 29Z98
Council Approval: 23 March 1998

SCHEDULE B

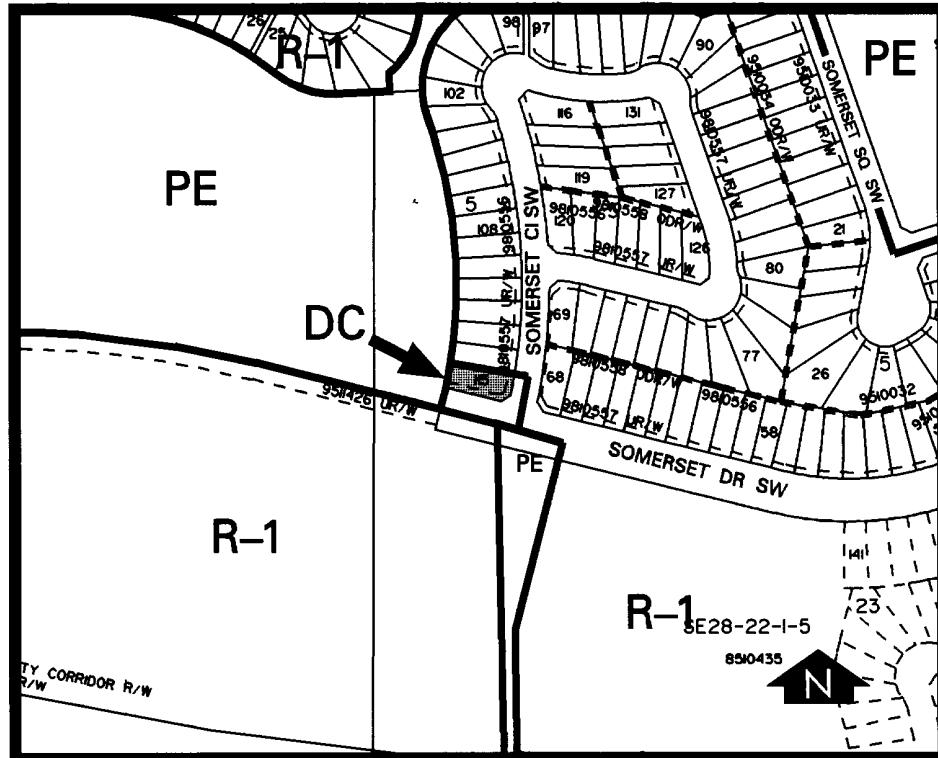

1. Land Use
The permitted use shall be a Child Care Facility only.
2. The general rules for residential districts contained in Section 20 of Bylaw 2P80 and the permitted use rules of the R-1 residential single-detached district shall apply unless otherwise noted below.
 1. Child Care Facility capacity
The maximum number of children shall be 60.
 2. Signage

Only one fascia sign to the satisfaction of the Approving Authority shall be allowed on the site (building).

3. Development Plans

Approval of this Application does not constitute an approval of a development permit. Comprehensive plans shall be submitted to the Approving Authority as part of development permit application. In considering such an application, the Approving Authority shall ensure that the building and site layout, landscaping and grading conform substantially to plans and renderings submitted to City Council during their consideration of the bylaw.