

Amendment No. 97/123
Bylaw No. 39Z98
Council Approval: 02 July 1999

SCHEDULE B

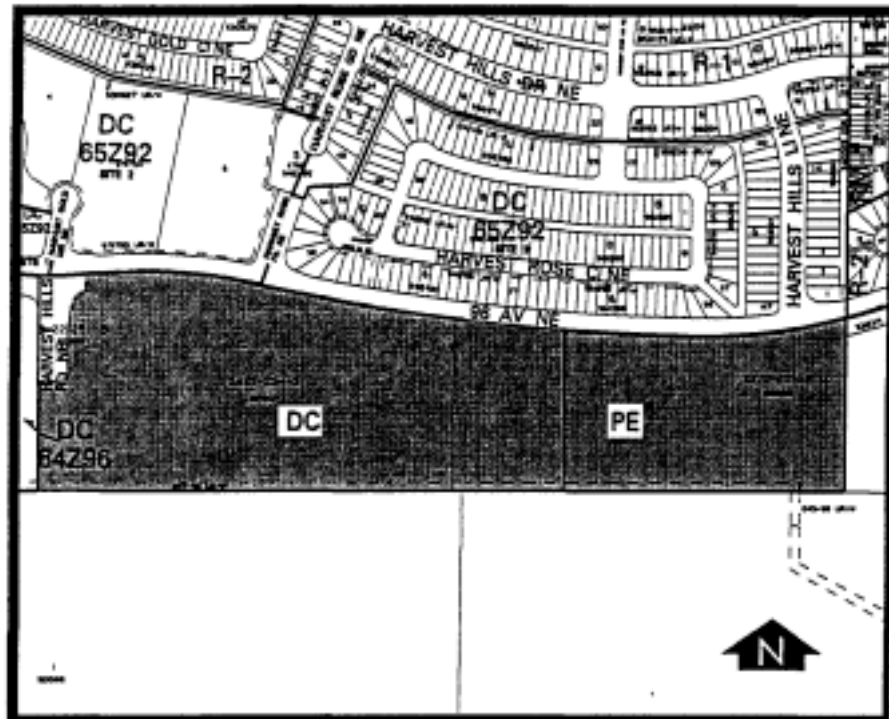

1. Land Use

The Permitted and Discretionary Uses of the I-2 General Light Industrial District shall be the Permitted and Discretionary uses respectively.

2. Development Guidelines

The General Rules for Industrial Districts contained in Section 43 of By-law 2P80 and the Permitted and Discretionary Use Rules of the I-2 District shall apply unless otherwise noted below:

a) Interface Treatment

Where a site abuts a residential district the treatment of the interface in terms of visual screening and landscaping shall be to the satisfaction of the Approving Authority.

b) Building Design

The design, character and appearance of buildings shall be compatible with the surrounding area and shall be constructed of durable materials designed to maintain the initial quality throughout the life of the project.

c) Development Plans

Approval of this bylaw does not constitute approval of a development permit. Comprehensive plans shall be submitted to the Development Authority as part of a development permit application.

d) Landscaping

All yards abutting 96 Avenue N.E. shall be bermed and landscaped to a minimum depth of 7.5 m in a manner satisfactory to the Approving Authority.