

Amendment No. 2000/054
Bylaw No. 118Z2000
Council Approval: 02 October 2000

SCHEDULE B

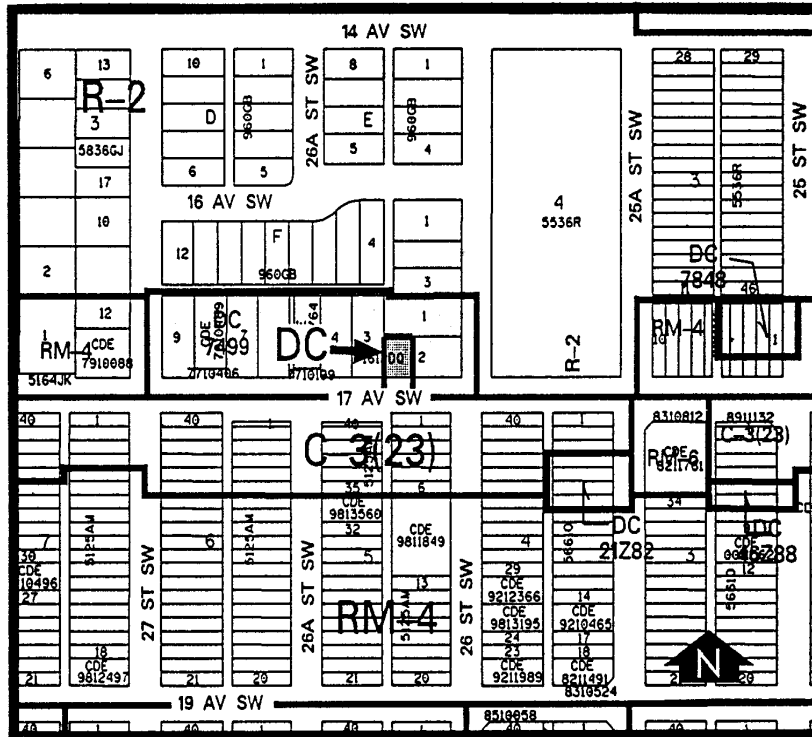

1. Land Use

The Permitted and Discretionary Uses of the RM-4 Residential Medium Density Multi-Dwelling District of Bylaw 2P80 shall be the Permitted and Discretionary Uses respectively with the additional Discretionary Use of offices within the main floor only, of the building existing on the site on the date of passage of this Bylaw.

2. Development Guidelines

The General Rules for Residential Districts contained in Section 20 of Bylaw 2P80 and the Permitted and Discretionary Rules of the RM-4 Residential Medium Density Multi-Dwelling District shall apply unless otherwise noted below.

(a) Office Use

Office uses may be allowed on the first floor only.

(b) Parking

Parking shall be provided to the satisfaction of the Approving Authority.

(c) Signage

Signage shall be limited to a wall mounted identification sign, shall not be illuminated, and must be compatible with the existing structure to the satisfaction of the Approving Authority.

(d) Development Plans

Approval of this application does not constitute approval of a development permit. A development permit application shall subsequently be submitted to the Approving Authority for approval.