

Amendment No. 99/148
Bylaw No. 35Z2000
Council Approval: 13 March 2000

SCHEDULE B

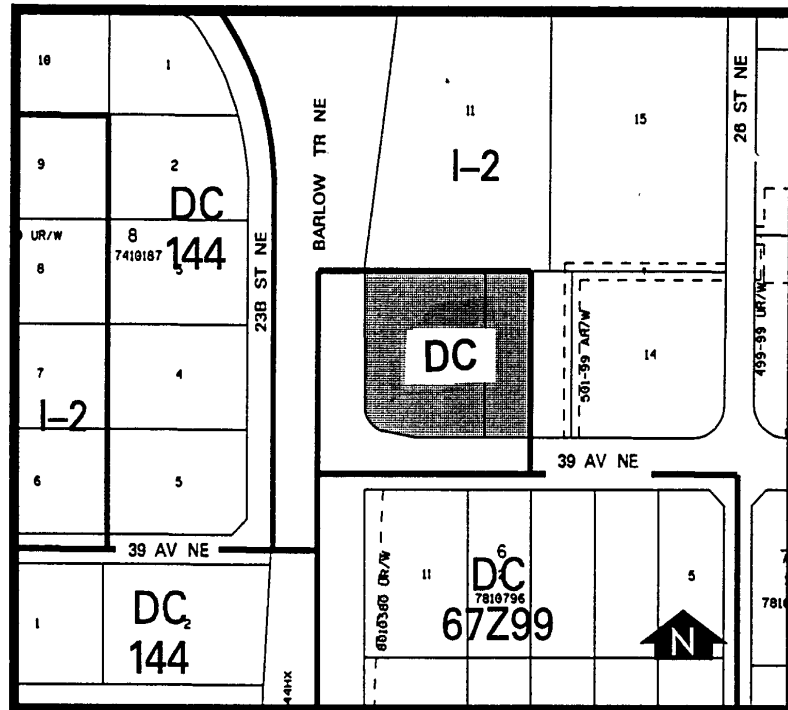

1. Land Use

The Permitted and Discretionary Uses of the I-2 General Light Industrial District of Bylaw 2P80 shall be the Permitted and Discretionary Uses respectively.

2. Development Guidelines

The General Rules for Industrial Districts contained in Section 43 of Bylaw 2P80 and the Permitted and Discretionary Use Rules of the I-2 General Light Industrial District shall apply except as otherwise noted below:

(a) Restaurant

Section 45(5)(e) shall not apply to this site.

(b) Development Plans

Approval of this bylaw does not constitute approval of a development permit.
Comprehensive plans shall be submitted to the Development Authority as part of a
development permit application.