

Amendment No. 99/106
Bylaw No. 4Z2000
Council Approval: 17 January 2000

SCHEDULE B

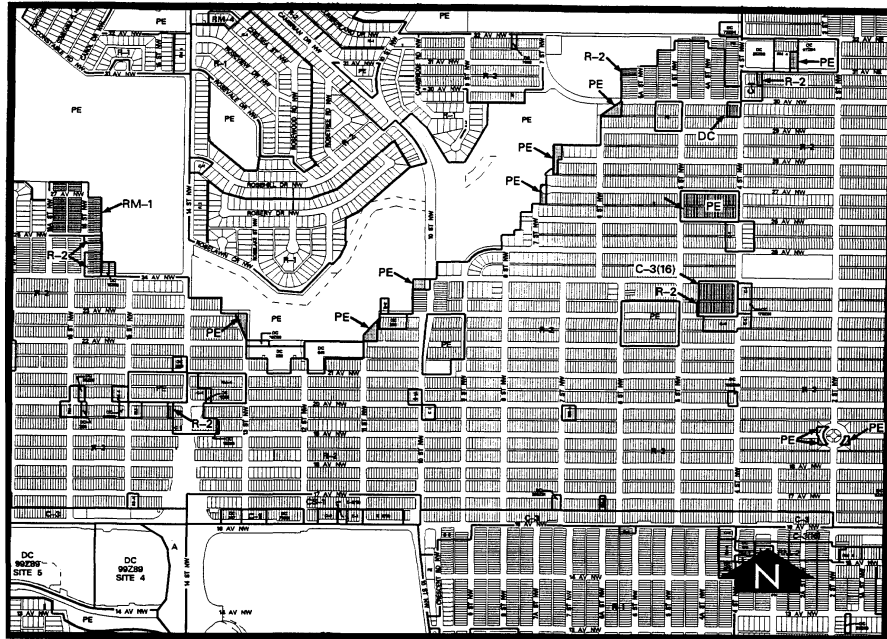

1. Land Use

The Permitted and Discretionary Uses of the R-2 Residential Low Density District shall be the Permitted and Discretionary Uses respectively with the additional Discretionary Use of offices.

2. Development Guidelines

The General Rules for Residential Districts contained in Section 20 of Bylaw 2P80 and the Permitted and Discretionary Use Rules of the R-2 Residential Low Density District shall apply unless otherwise noted below:

- (a) Offices in buildings existing as of the date of passage of this Bylaw:
 - (i) Signage shall not be illuminated and shall be limited in size, design and location and compatible with the residential neighbourhood, all to the satisfaction of the Approving Authority.
 - (ii) No material, equipment or commercial vehicles shall be stored on site.
- (b) New Office Buildings

The General Rules for Commercial Districts contained in Section 33 of Bylaw 2P80 and the Permitted and Discretionary Use Rules of the C-1 Local Commercial District shall apply.

(c) Development Plans

Approval of this application does not constitute approval of a development permit. Comprehensive plans shall be submitted to the Approving Authority as part of a development permit application.