

Amendment No. 2000/060
Bylaw No. 82Z2000
Council Approval: 24 July 2000

SCHEDULE B

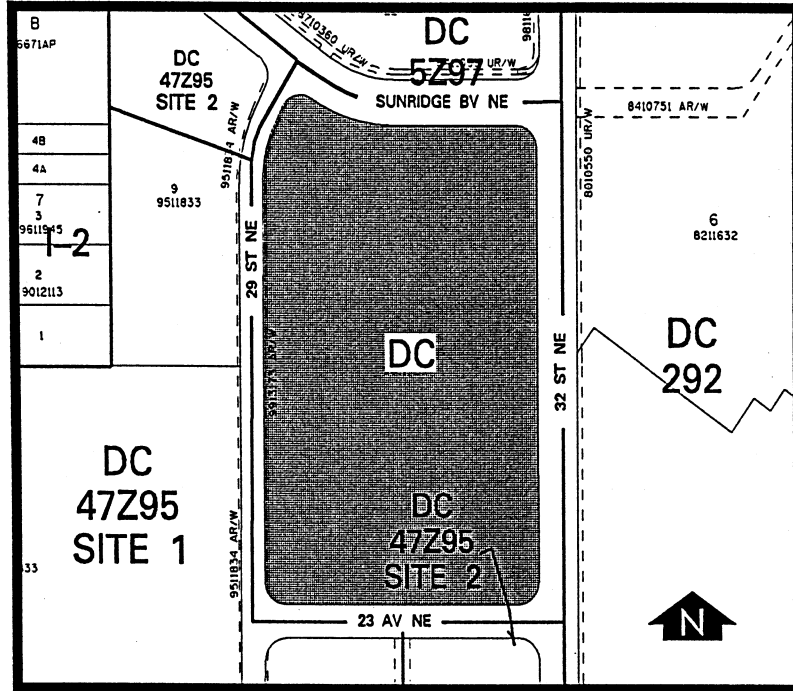

1. Land Use

The land use shall be for entertainment establishments, retail stores, personal service businesses, restaurant/drinking establishments, financial institutions and outdoor cafes, all as Discretionary Uses.

2. Development Guidelines

The General Rules for Commercial Districts contained in Section 33 of Bylaw 2P80 and the Permitted and Discretionary Use Rules of the C-5 Shopping Centre Commercial District shall apply unless otherwise noted below:

a. Capacity

The maximum restaurant/drinking establishment capacity and the maximum gross floor area for retail stores that can be approved shall be determined following approval of the development permit for the entertainment establishment and shall be based upon the available residual on-site parking, all to the satisfaction of the Approving Authority.

b. Site Development

A comprehensive site plan identifying all parking, access, pedestrian movement corridors, and landscaping provisions shall form part of, and be approved with, the first development permit application for the site.

c. Parking Areas

Large parking areas shall be made visually discontinuous through the use of landscaping which may include berms, terraces, planters, vegetation, and/or similar treatments all to the satisfaction of the Development Authority.

A minimum of 1250 parking stalls shall be maintained on site at all times.

d. Signage

As part of the comprehensive signage proposal, signs shall be limited in size, design and location and must be compatible with the architectural design of the buildings on site.

e. Development Plans

Approval of this application does not constitute approval of a development permit. Comprehensive plans shall be submitted to the Development Authority as part of a development permit application.