

Amendment # LOC2002-0022
Bylaw # 111Z2002
Council Approval: February 24 2003

SCHEDULE B

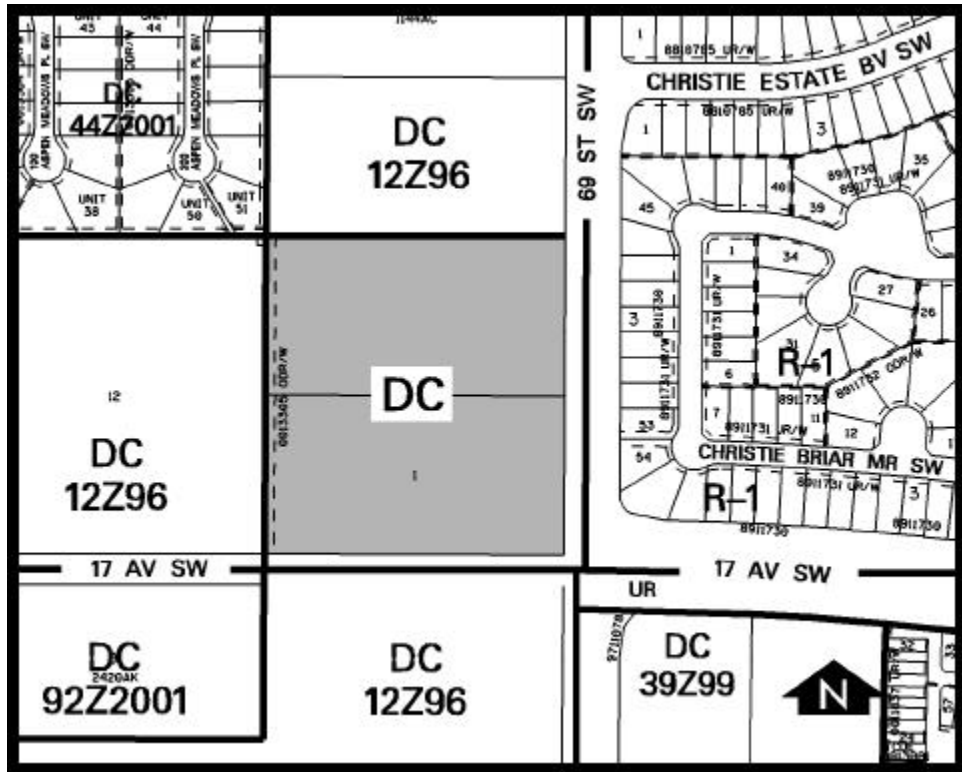

DC DIRECT CONTROL DISTRICT

1. Land Use

The Permitted and Discretionary Uses of the RM-4 Residential Medium Density Multi-Dwelling District of Bylaw 2P80 shall be the Permitted and Discretionary Uses respectively.

2. Development Guidelines

The General Rules for Residential Districts contained in Section 20 and the Permitted and Discretionary Use Rules of the RM-4 Residential Medium Density Multi-Dwelling District of Bylaw 2P80 shall apply unless otherwise noted below:

(a) Density

The net site shall contain a maximum of 64 dwelling units and a minimum of 50 dwelling units.

(b) Parking

All resident parking shall be underground with a minimum of two parking stalls provided per residential unit.

(c) Access

No permanent access will be allowed to or from either 69 Street SW or 17 Avenue SW.

(d) Landscaping

A minimum of 60 percent of the net site shall be landscaped and all adjoining City boulevards to the satisfaction of the Approving Authority.