

**Amendment # 2001/029**  
**Bylaw # 6Z2002**  
Council Approval: 2002 January 21

**SCHEDULE B**

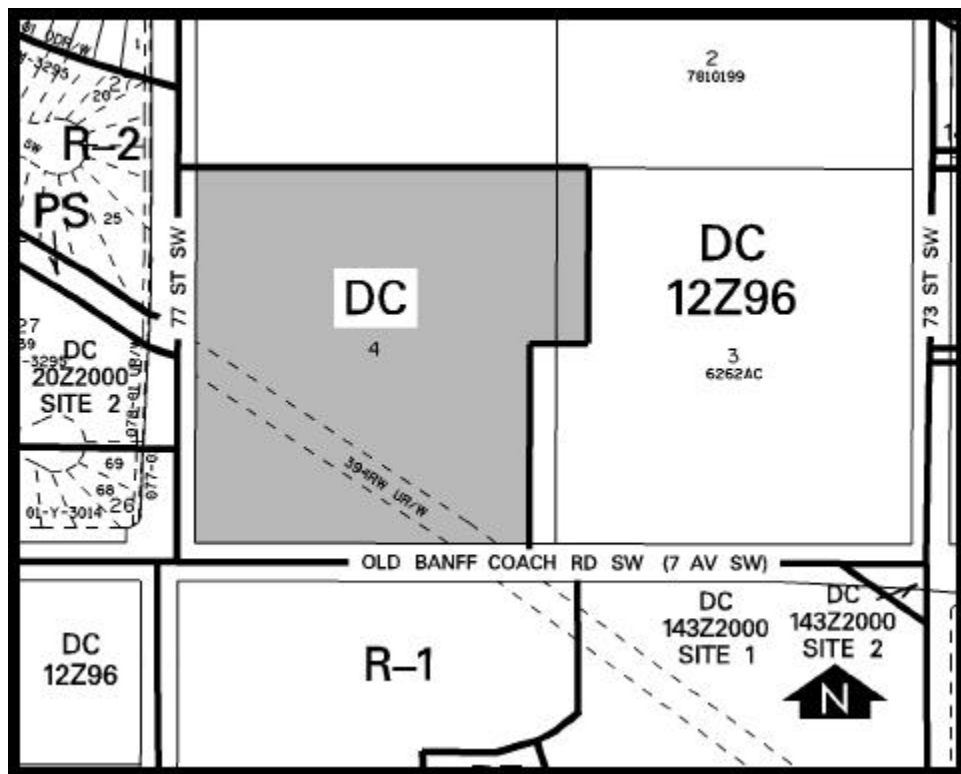

**DC DIRECT CONTROL DISTRICT**

1. Land Use  
Utilities shall be a Permitted Use and a private school shall be a Discretionary Use.
2. Development Guidelines

The General Rules for Special Districts contained in Section 48 of Bylaw 2P80 and the Permitted and Discretionary Use Rules of the PE Public Park, School and Recreation District shall apply unless otherwise noted below:

(a) Capacity

A maximum of 900 students.

(b) Yards

A minimum depth of 5 metres for yards fronting 77 Street SW and Old Banff Coach Road SW and a minimum depth of 7.5 metres for all other yards.

(c) Height

The maximum height shall be 14 metres to any eaveline.

(d) Landscaped Area

A minimum of 40 percent of the site area plus all adjoining City boulevards.

(e) Parking

Parking shall be provided in accordance with Section 18 of Bylaw 2P80 with a maximum of 20 required stalls being located within the existing electrical transmission Utility Right-of-Way.

(f) Site Access

Vehicle access/egress shall be to or from 77 Street SW only.

(g) Development Plans

Approval of this application does not constitute approval of a development permit. Comprehensive plans shall be submitted to the Approving Authority as part of a development permit application. In considering the development permit application, the Approving Authority shall ensure the site layout is generally consistent with the Proposed Site Plan available to City Council during its consideration of this Bylaw.