

**Amendment # LOC2002-0067
Bylaw # 90Z2002
Council Approval: September 23 2002**

SCHEDULE B

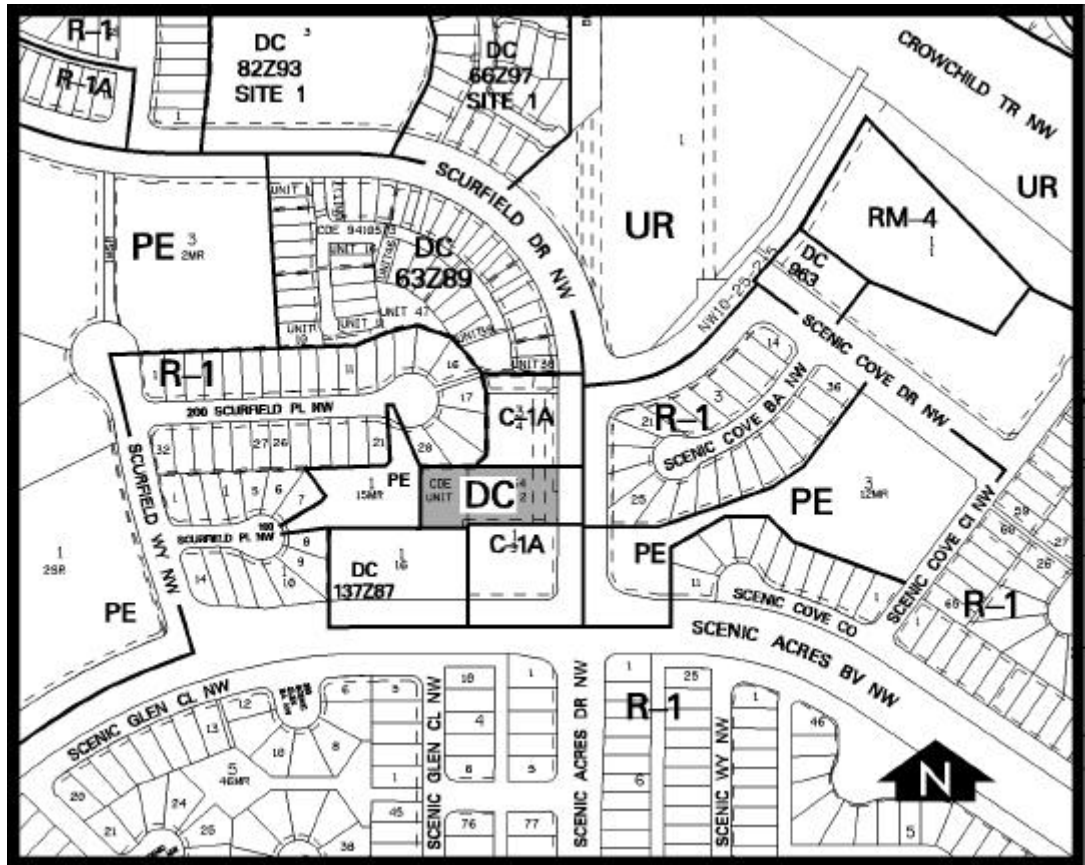

DC – DIRECT CONTROL DISTRICT

1. Land Use

The Permitted and Discretionary Uses of the C-1 Local Commercial District of Bylaw 2P80 shall be the Permitted and Discretionary Uses respectively, excluding restaurant/drinking establishments, liquor stores and billiard parlours.

2. Development Guidelines

The General Rules for Commercial Districts contained in Section 33 of Bylaw 2P80 and the Permitted and Discretionary Use Rules of the C-1 Local Commercial District shall apply unless otherwise noted below:

(a) Building Setback

(i) Buildings shall be setback a minimum of 5 metres from a property line abutting residential properties; and

(ii) A setback area provided under (i) above shall be landscaped.

(b) Building Design

Windows at the second storey level facing onto abutting residential properties shall be opaque.