

**Amendment # LOC2001-0043
Bylaw # 47Z2003
Council Approval 2003 May 12**

SCHEDULE B

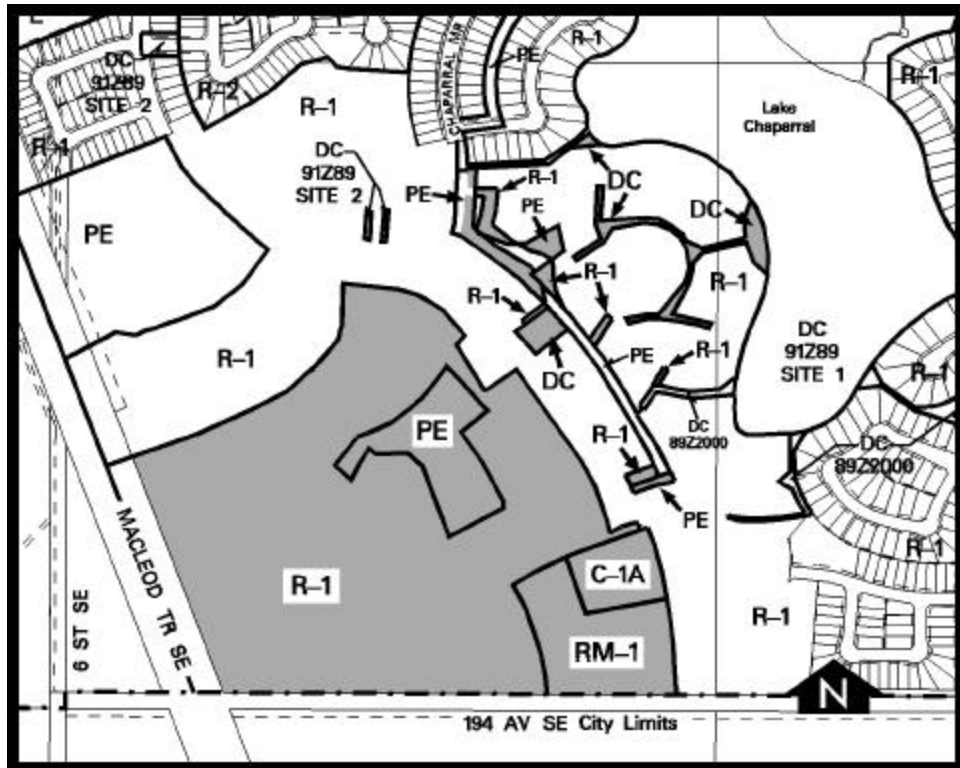

DC DIRECT CONTROL DISTRICT

1. Land Use

The Discretionary Uses shall be privately owned and maintained ornamental entrance parks, walkways and associated community signage only.

2. Development Guidelines

The General Rules for Residential Districts contained in Section 48 of Bylaw 2P80 and the Permitted and Discretionary Use Rules of the A Agricultural and Open Space District shall apply unless otherwise noted below:

Development Approvals

The ornamental entrance parks and associated community identification signage shall be developed to the satisfaction of the Development Authority.