

**Amendment # LOC2003-0026**  
**Bylaw # 48Z2003**  
Council Approval: 2003 May 12

**SCHEDULE B**

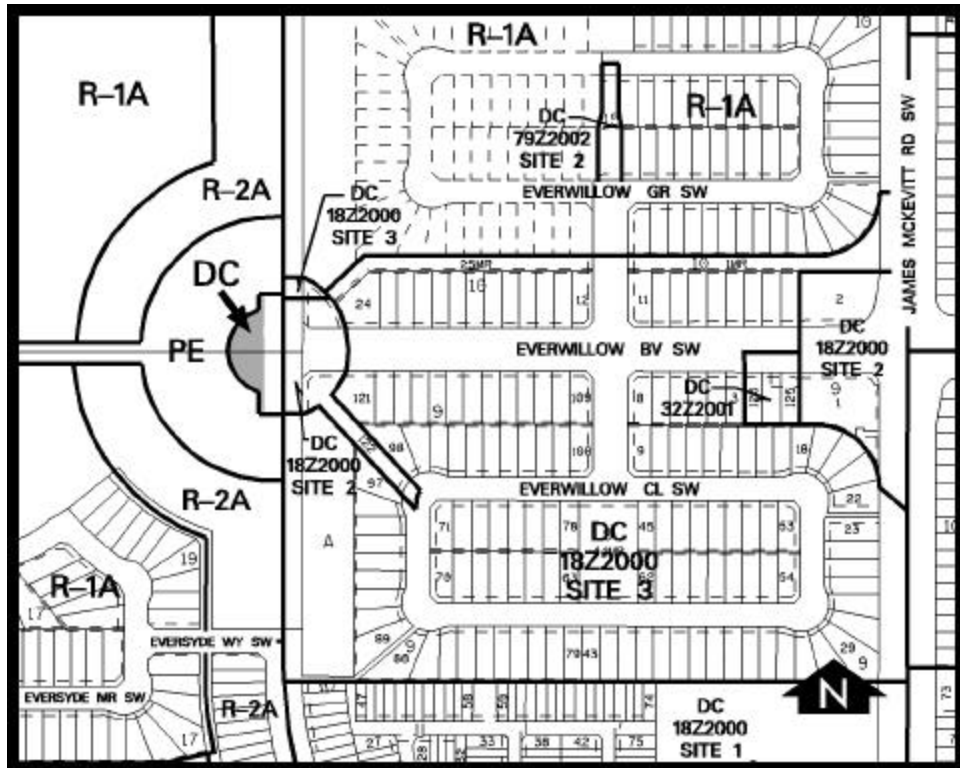

**DC DIRECT CONTROL DISTRICT**

1. Land Use

The land use shall be the Discretionary Uses of parks and community identification signs.

2. Development Guidelines

(a) Parks

Parks shall be designed and landscaped to the satisfaction of the Approving Authority.

(b) Signage

Signs shall be designed and located to the satisfaction of the Approving Authority.