

# Amendment # LOC2003-0145 Bylaw # 34Z2004

Council Approval: 2004 May 10

## SCHEDULE B

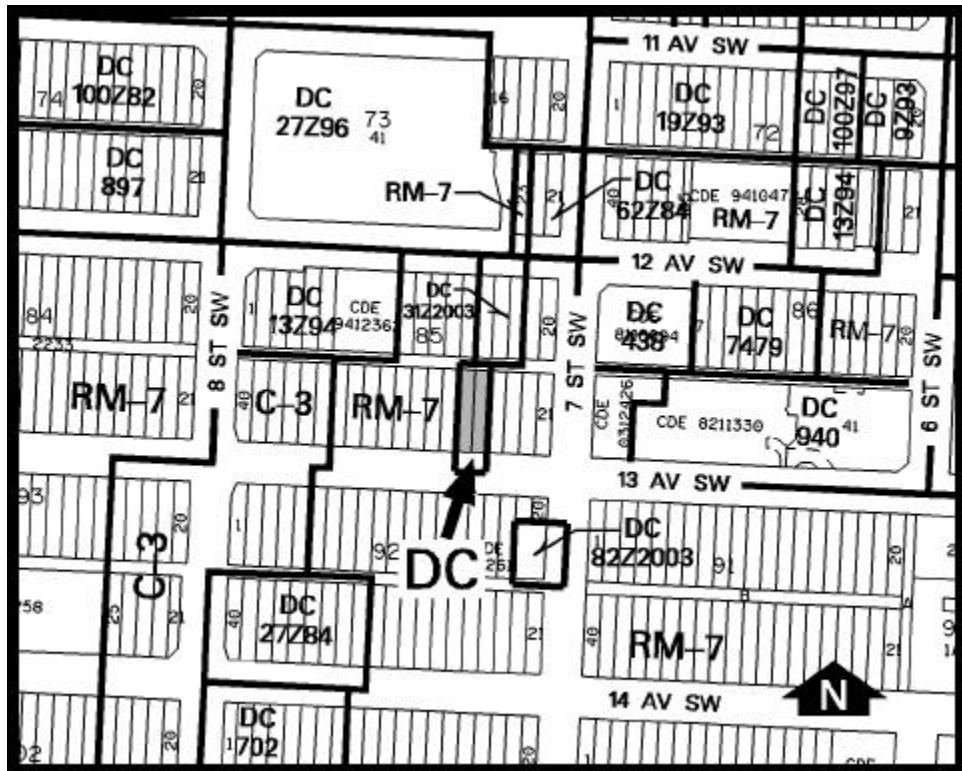

### DC DIRECT CONTROL DISTRICT

1. Land Use

The Permitted and Discretionary Uses of the RM-7 Residential High Density Multi-Dwelling District of Bylaw 2P80 shall be the Permitted and Discretionary Uses respectively with the additional Discretionary Use of offices within the building existing on the site on the date of passage of this Bylaw.

2. Development Guidelines

The General Rules for Residential Districts contained in Section 20 of Bylaw 2P80 and the Permitted and Discretionary Use Rules of the RM-7 Residential High Density Multi-Dwelling District shall apply unless otherwise noted below:

(a) Signage

Signage shall be limited in size, design and location and must be compatible with the residential neighbourhood, to the satisfaction of the Development Authority.