

Amendment # LOC2003-0120
Bylaw # 6Z2004
Council Approval: 2004 March 08

SCHEDULE B

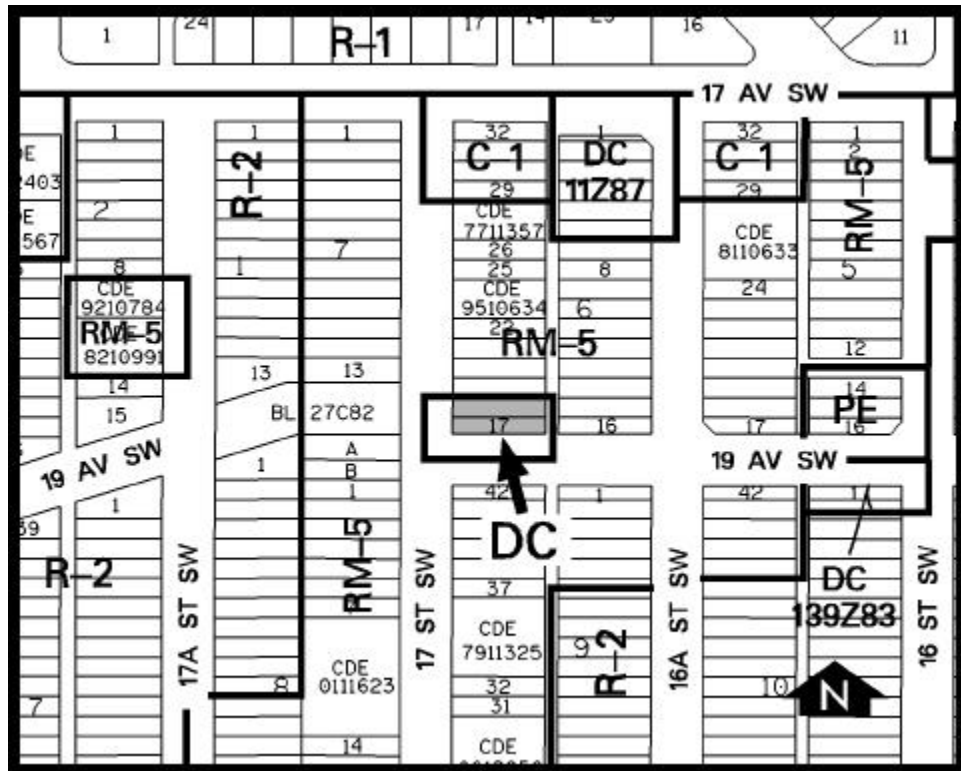

DC – DIRECT CONTROL

1. Land Use
The Permitted and Discretionary Uses of the RM-5 Residential Medium Density District of Bylaw 2P80 shall be the Permitted and Discretionary Uses respectively.
2. Development Guidelines
The General Rules for Residential Districts contained in Section 20 of Bylaw 2P80 and the Permitted and Discretionary Use Rules of the RM-5 Residential Medium Density District shall apply unless otherwise noted below:
 - (a) Density
A maximum of 4 units may be allowed on this site.
 - (b) Dwelling Unit Access
Each dwelling unit shall have a separate, direct entrance from grade or a landscaped area.