

BYLAW NUMBER 5D2009

**BEING A BYLAW OF THE CITY OF CALGARY
TO AMEND THE LAND USE BYLAW 1P2007
(LAND USE AMENDMENT LOC2008-0083)**

WHEREAS it is desirable to amend the Land Use Bylaw Number 1P2007 to change the land use designation of certain lands within the City of Calgary;

AND WHEREAS Council has held a public hearing as required by Section 692 of the *Municipal Government Act*, R.S.A. 2000, c.M-26 as amended;

NOW, THEREFORE, THE COUNCIL OF THE CITY OF CALGARY ENACTS AS FOLLOWS:

1. The Land Use Bylaw, being Bylaw 1P2007 of the City of Calgary, is hereby amended by deleting that portion of the Land Use District Map shown as shaded on Schedule "A" to this Bylaw and substituting therefor that portion of the Land Use District Map shown as shaded on Schedule "B" to this Bylaw, including any land use designation, or specific land uses and development guidelines contained in the said Schedule "B".
2. This Bylaw comes into force on the date it is passed.

READ A FIRST TIME THIS 12th DAY OF JANUARY, 2009.

READ A SECOND TIME THIS 12th DAY OF JANUARY, 2009.

READ A THIRD TIME THIS 12th DAY OF JANUARY, 2009.

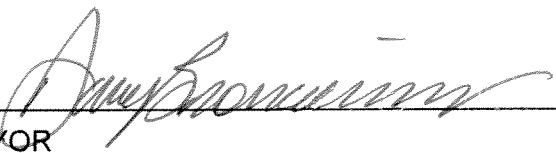

MAYOR

SIGNED THIS 12th DAY OF JANUARY, 2009.



ACTING CITY CLERK

SIGNED THIS 12th DAY OF JANUARY, 2009.

AMENDMENT LOC2008-0083
BYLAW NUMBER 5D2009

SCHEDULE A

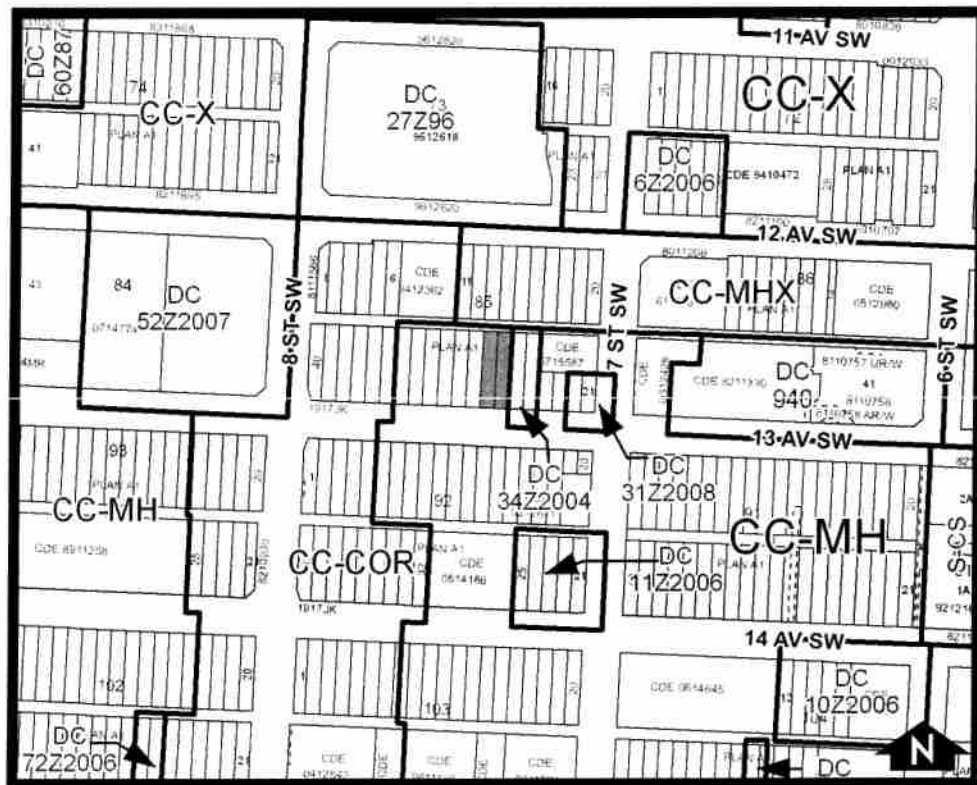

AMENDMENT LOC2008-0083
BYLAW NUMBER 5D2009

SCHEDULE B

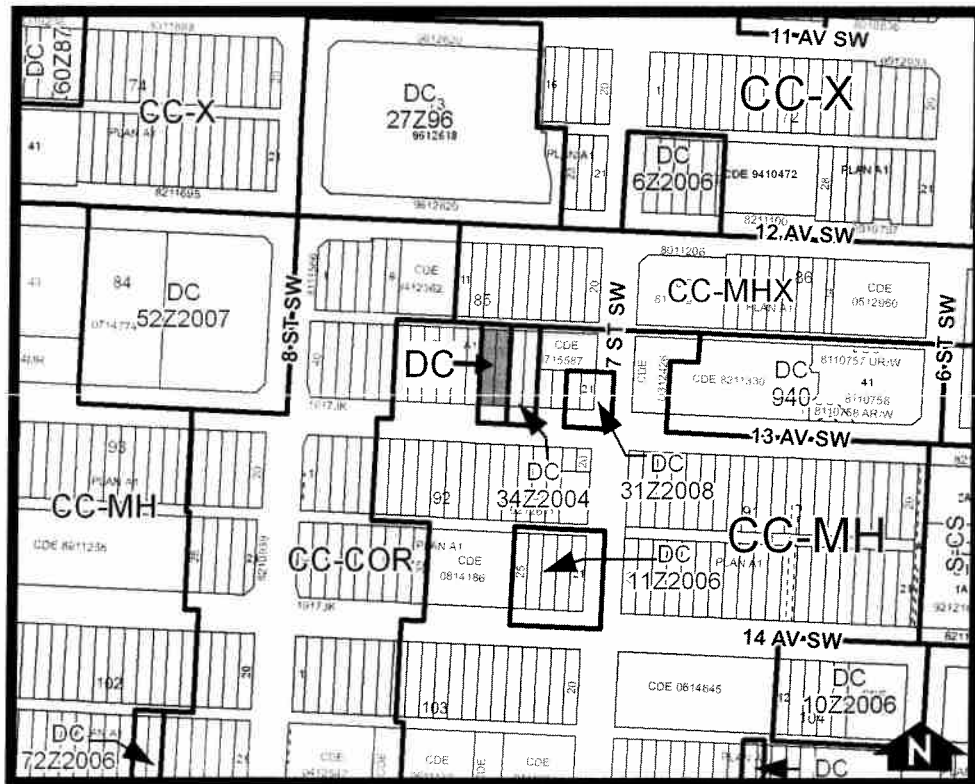

DC DIRECT CONTROL DISTRICT

Purpose

- 1 This Direct Control District is intended to provide for:
 - a) an **Office** in the building existing as of the date of this Bylaw only; and
 - b) the retention of the *permitted* and *discretionary uses* of the CC-MH Centre City Multi – Residential High Rise District.

**AMENDMENT LOC2008-0083
BYLAW NUMBER 5D2009**

CONTINUED

Compliance with Bylaw 1P2007

- 2 Unless otherwise specified, the rules and provisions of Sections 1 through 4 of Part 1, Sections 21 (1), (2) and 22 of Part 2 and Part 11 apply to this Direct Control District.

Reference to Bylaw 1P2007

- 3 Within this Direct Control District, a reference to a section or Part of Bylaw 1P2007 is deemed to be a reference to the section or Part as amended from time to time.

Permitted Uses

- 4 The *permitted* uses of the CC-MH Centre City Multi – Residential High Rise District of Part 11 of Bylaw 1P2007 are the *permitted uses* in this Direct Control District.

Discretionary Uses

- 5 The *discretionary* uses of the CC-MH Centre City Multi – Residential High Rise District of Part 11 of Bylaw 1P2007 are the *discretionary uses* in this Direct Control District with the addition of **Office**.

Bylaw 1P2007 District Rules

- 6 Unless otherwise specified, the rules of the CC-MH Centre City Multi – Residential High Rise District of Part 11 of Bylaw 1P2007 apply in this Direct Control District.

Signage

- 7 A maximum of one freestanding sign on site, with a maximum sign area of 1 square metre.