

BYLAW NUMBER 83D2014

**BEING A BYLAW OF THE CITY OF CALGARY
TO AMEND THE LAND USE BYLAW 1P2007
(LAND USE AMENDMENT LOC2012-0074)**

WHEREAS it is desirable to amend the Land Use Bylaw Number 1P2007 to change the land use designation of certain lands within the City of Calgary;

AND WHEREAS Council has held a public hearing as required by Section 692 of the Municipal Government Act, R.S.A. 2000, c.M-26 as amended;

NOW, THEREFORE, THE COUNCIL OF THE CITY OF CALGARY ENACTS AS FOLLOWS:

1. The Land Use Bylaw, being Bylaw 1P2007 of the City of Calgary, is hereby amended by deleting that portion of the Land Use District Map shown as shaded on Schedule "A" to this Bylaw and substituting therefor that portion of the Land Use District Map shown as shaded on Schedule "B" to this Bylaw, including any land use designation, or specific land uses and development guidelines contained in the said Schedule "B".
2. This Bylaw comes into force on the date it is passed.

READ A FIRST TIME THIS 8TH DAY OF SEPTEMBER, 2014.

READ A SECOND TIME, AS AMENDED, THIS 8TH DAY OF SEPTEMBER, 2014.

READ A THIRD TIME, AS AMENDED, THIS 8TH DAY OF SEPTEMBER, 2014.

MAYOR
SIGNED THIS 3RD DAY OF OCTOBER, 2014.

ACTING CITY CLERK
SIGNED THIS 3RD DAY OF OCTOBER, 2014.

SCHEDULE A

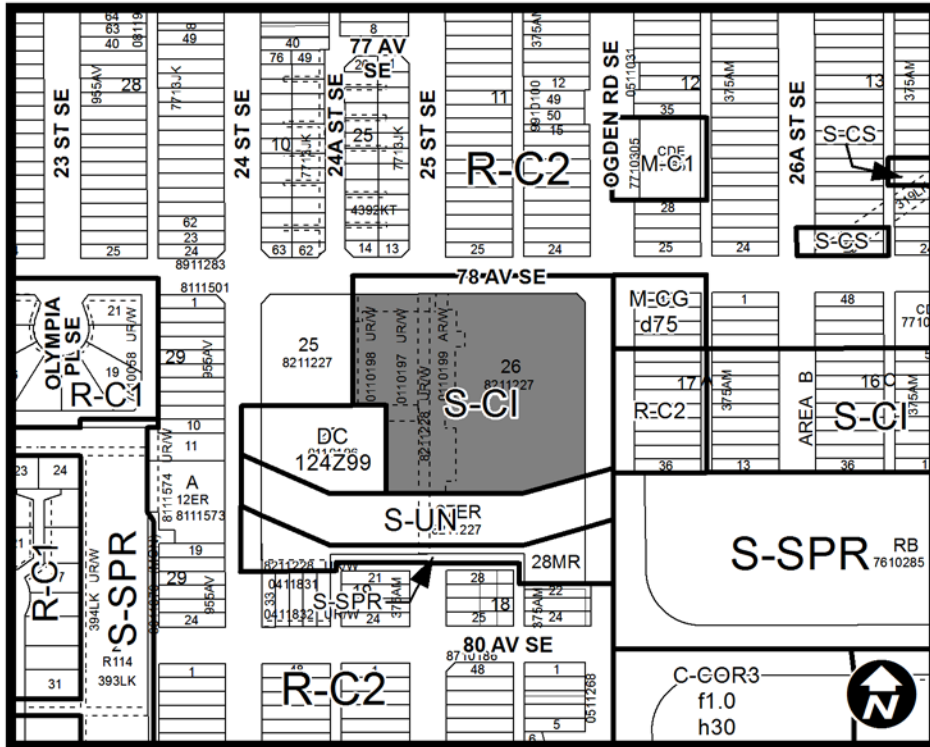

SCHEDULE B

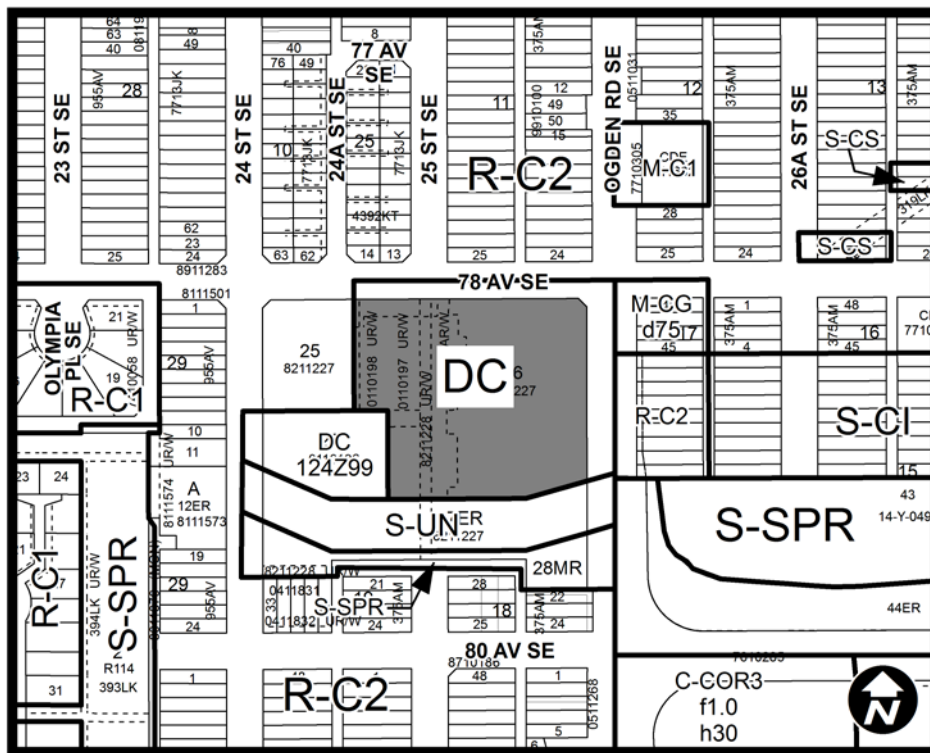

Purpose

- 1 This Direct Control District is intended to:
 - (a) Establish **development** controls for the subject site; and
 - (b) limit undesired **uses** on the site.

Compliance with Bylaw 1P2007

- 2 Unless otherwise specified, the rules and provisions of Parts 1, 2, 3 and 4 of Bylaw 1P2007 apply to this Direct Control District.

**AMENDMENT LOC2012-0074
BYLAW NUMBER 83D2014**

Reference to Bylaw 1P2007

- 3** Within this Direct Control District, a reference to a section of Bylaw 1P2007 is deemed to be a reference to the section as amended from time to time.

Permitted Uses

- 4** The ***permitted uses*** of the Commercial – Corridor 1 (C-COR1) District of Bylaw 1P2007 are the ***permitted uses*** in this Direct Control District.

Discretionary Uses

- 5** The ***discretionary uses*** of the Commercial – Corridor 1 (C-COR1) District of Bylaw 1P2007 are the ***discretionary uses*** in this Direct Control District with the exclusion of:

- (a) **Billiard Parlour;** and
- (b) **Pawn Shop.**

Bylaw 1P2007 District Rules

- 6** Unless otherwise specified, the rules of the Commercial – Corridor 1 (C-COR1) District of Bylaw 1P2007 apply in this Direct Control District.

Floor Area Ratio

- 7** The maximum ***floor area ratio*** is 1.0.

Building Height

- 8** The maximum ***building height*** is 16.0 metres.