

BYLAW NUMBER 12D2019

**BEING A BYLAW OF THE CITY OF CALGARY
TO AMEND THE LAND USE BYLAW 1P2007
(LAND USE AMENDMENT
LOC2018-0168/CPC2018-1304)**

WHEREAS it is desirable to amend the Land Use Bylaw Number 1P2007 to change the land use designation of certain lands within the City of Calgary;

AND WHEREAS Council has held a public hearing as required by Section 692 of the Municipal Government Act, R.S.A. 2000, c.M-26 as amended;

NOW, THEREFORE, THE COUNCIL OF THE CITY OF CALGARY ENACTS AS FOLLOWS:

1. The Land Use Bylaw, being Bylaw 1P2007 of the City of Calgary, is hereby amended by deleting that portion of the Land Use District Map shown as shaded on Schedule "A" to this Bylaw and substituting therefor that portion of the Land Use District Map shown as shaded on Schedule "B" to this Bylaw, including any land use designation, or specific land uses and development guidelines contained in the said Schedule "B".
2. This Bylaw comes into force on the date it is passed.

READ A FIRST TIME ON JANUARY 14, 2019

READ A SECOND TIME ON JANUARY 14, 2019

READ A THIRD TIME ON JANUARY 14, 2019



MAYOR
SIGNED ON JANUARY 14, 2019



ACTING CITY CLERK
SIGNED ON JANUARY 14, 2019

AMENDMENT LOC2018-0168/CPC2018-1304
BYLAW NUMBER 12D2019

SCHEDULE A

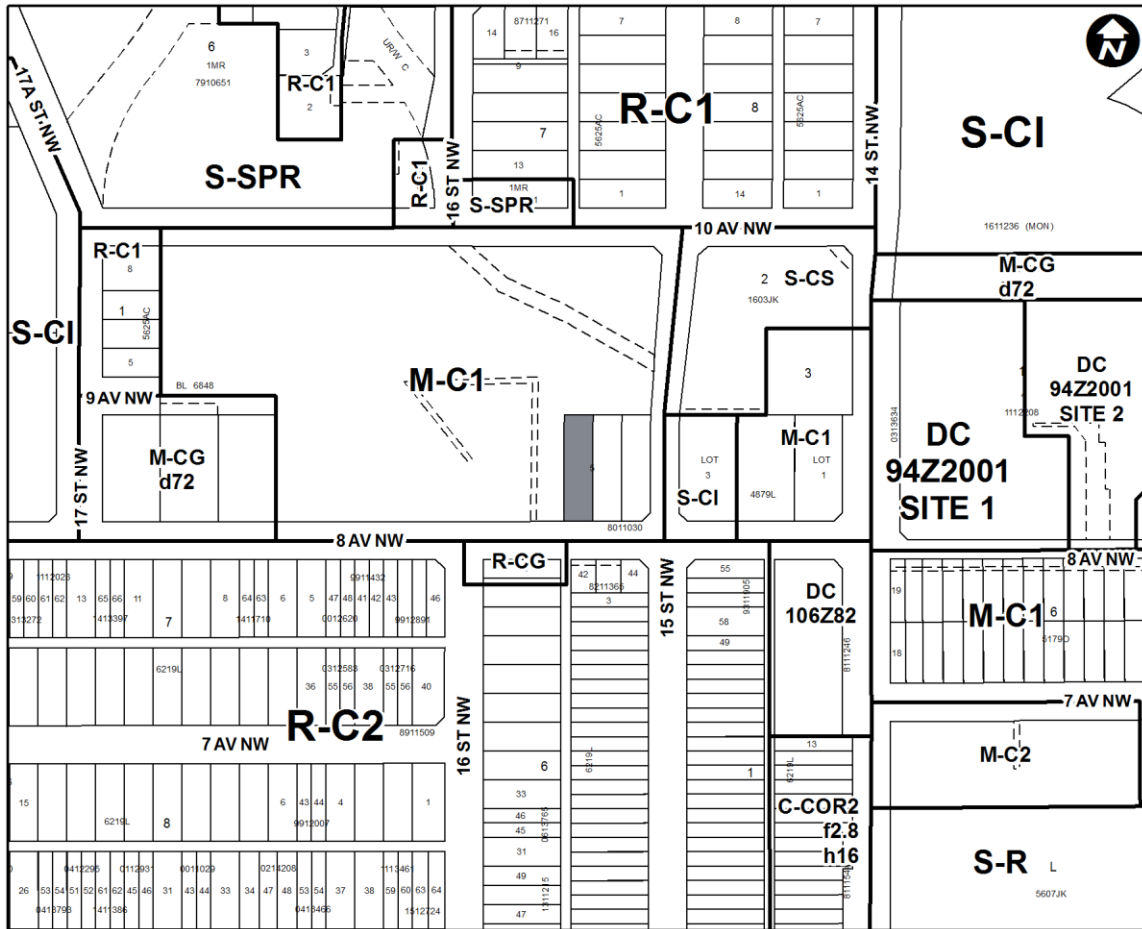

SCHEDULE B

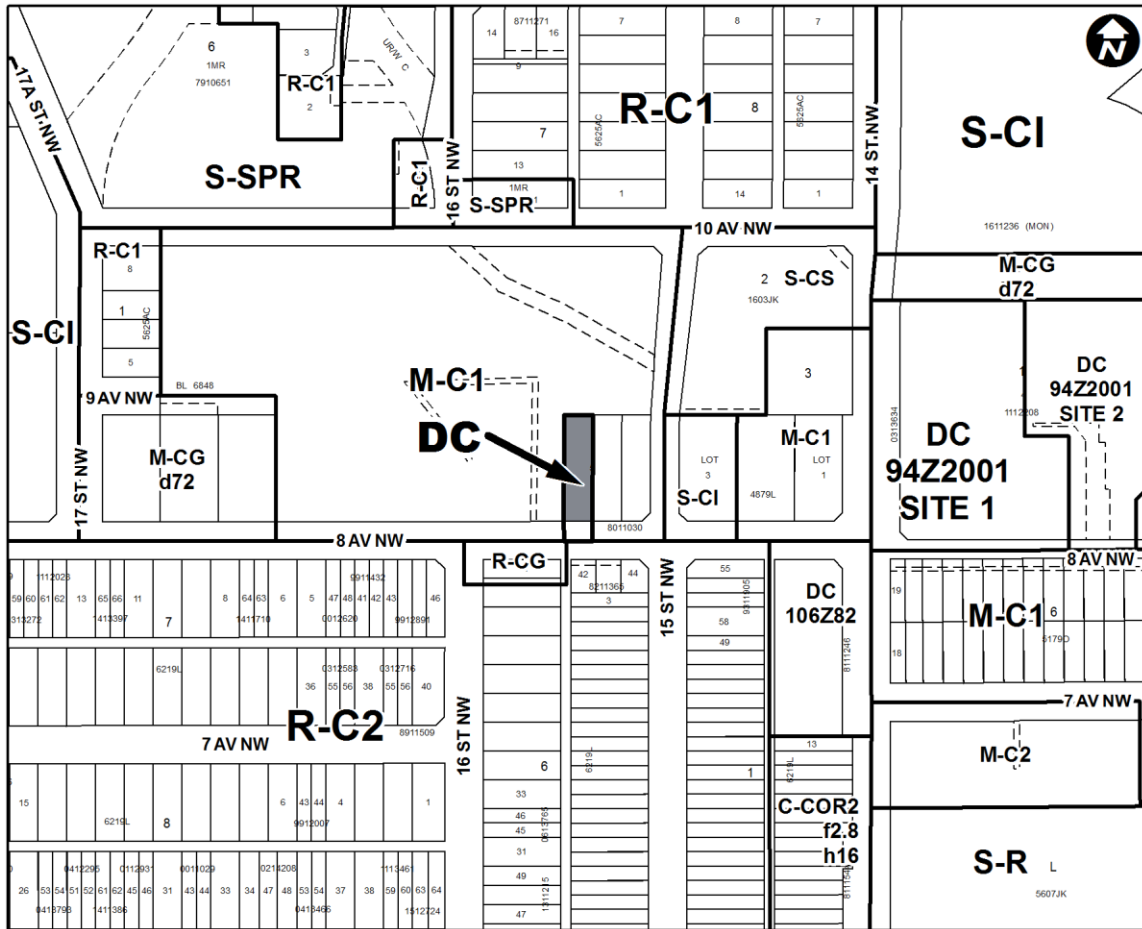

DIRECT CONTROL DISTRICT

Purpose

- 1 This Direct Control District is intended to:
 - (a) align with the provisions of Multi-Residential – Contextual Low Profile (M-C1) District of Land Use Bylaw 1P2007;
 - (b) allow the additional *uses* of **Counselling Service, Medical Clinic, Office and Retail and Consumer Service**; and
 - (c) only allow **Retail and Consumer Service** in conjunction with a **Counselling Service, Medical Clinic or Office use**.

Compliance with Bylaw 1P2007

- 2 Unless otherwise specified, the rules and provisions of Parts 1, 2, 3 and 4 of Bylaw 1P2007 apply to this Direct Control District.

Reference to Bylaw 1P2007

- 3 Within this Direct Control District, a reference to a section of Bylaw 1P2007 is deemed to be a reference to the section as amended from time to time.

Permitted Uses

- 4 The **permitted uses** of the Multi-Residential – Contextual Low Profile (M-C1) District of Bylaw 1P2007 are the **permitted uses** of this Direct Control District.

Discretionary Uses

- 5 The **discretionary uses** of the Multi-Residential – Contextual Low Profile (M-C1) District of Bylaw 1P2007 are the **discretionary uses** in this Direct Control District with the addition of:

- (a) **Counselling Service;**
- (b) **Medical Clinic;**
- (c) **Office; and**
- (d) **Retail and Consumer Service.**

Bylaw 1P2007 District Rules

- 6 Unless otherwise specified, the rules of the Multi-Residential – Contextual Low Profile (M-C1) District of Bylaw 1P2007 apply in this Direct Control District.

Retail and Consumer Service Additional Rules

- 7 A **Retail and Consumer Service use** must only be approved as an ancillary **use** to the **uses** listed in Section 5 (a), (b) and (c) of this Direct Control District.