

Amendment No. 10-80
Bylaw No. 86Z80
Council Approval: 08 September 1980

SCHEDULE B

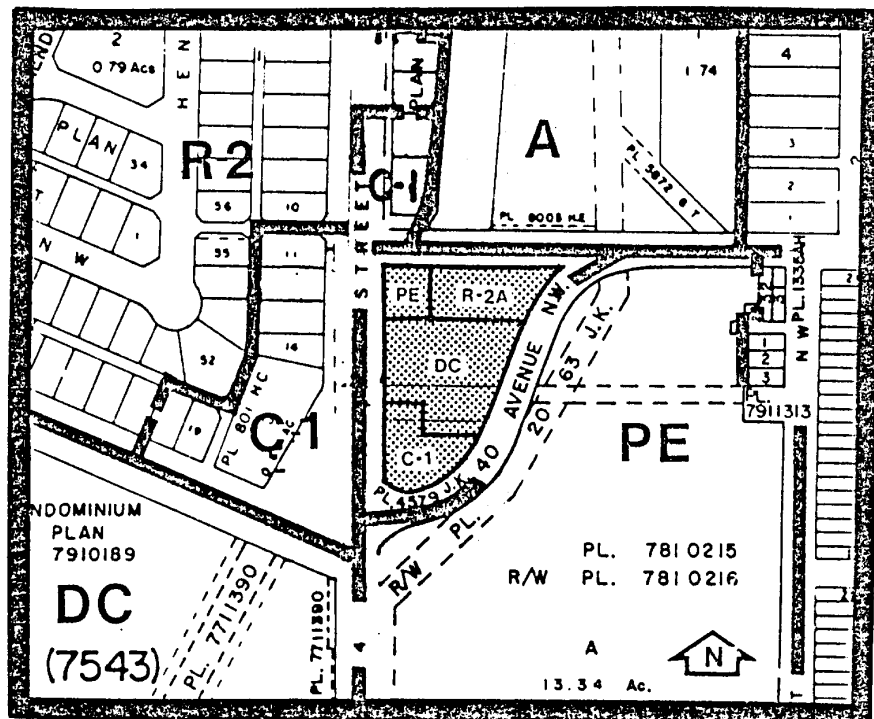

A.M. No.-10-80 L.U.C.G. or BY-LAW No. 86Z80

LAND USES FOR THE D.C. SITE

The land use shall be for a senior citizens apartment building only.

DEVELOPMENT GUIDELINES FOR THE D.C. SITE

The General Rules for Residential District contained in Section 20 of By-law 2P80, the Permitted Use Rules and Discretionary Use Rules of the RM-4 (Residential Medium-Density Multi-Dwelling District) shall apply unless otherwise noted below.

Building Height

A maximum of six storeys not exceeding 16 metres at any eaveline.