

Amendment No. 89/034
Bylaw No. 81Z89
Council Approval: 17 July 1989

SCHEDULE B

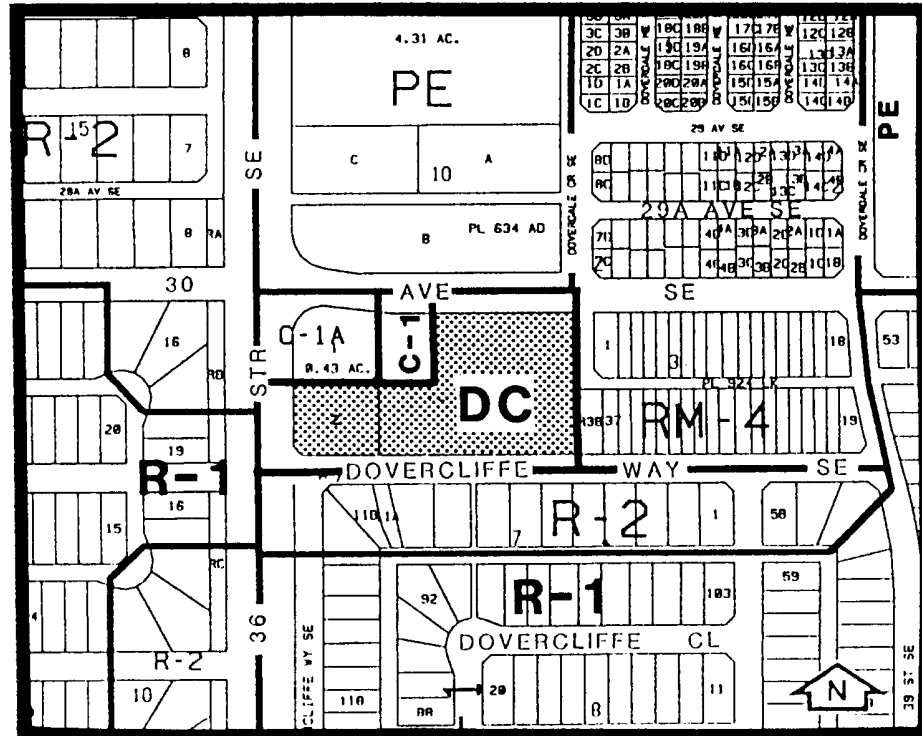

1) Land Use

To accommodate single-family detached residential development only.

2) Development Guidelines

The general rules for residential districts as contained in Section 20 of Land Use By-law 2P80 and the permitted and discretionary use rules of the R-2 district shall apply unless otherwise noted below.

a) Height

Buildings shall be a maximum of two storeys.

b) Yards

Side yards shall be a minimum of 1.2 metres.

c) Access

All lots shall have lane access.

d) Parking

Each lot shall provide a minimum of two parking spaces, on site.